

# Equip TV & OFFICE SOLUTIONS

mount IT with Equip



The Equip brand is driven by continuous product development with the goal of providing high quality solutions; while constantly adapting & responding to the dynamic demands of the marketplace.





ELECTRIC SIT-STAND FRAMES	06
ELECTRIC SIT STAND FRAME WITH DESKTOP	09
TABLE ACCESSORIES	10
CPU MOUNT	13
MONITOR DESK MOUNT SOLUTIONS	14
MONITOR WALL MOUNT SOLUTIONS	24
PREMIUM DESK MOUNT SOLUTIONS	28
PREMIUM MONITOR CONTENT	33
MONITOR STAND SOLUTIONS	34
WORKSTATION SOLUTIONS	40



TV MOUNT SOLUTIONS	42
MULTIMEDIA MOUNT SOLUTIONS	62
MOTORIZED MOUNT SOLUTIONS	64
TV STAND SOLUTIONS	70
TV CART SOLUTIONS	74
PROFESSIONAL TV CEILING SOLUTIONS	80
PROJECT MOUNT SOLUTIONS	86
PROFESSIONAL DIGITAL SIGNAGE SOLUTIONS	90





ergo



**EQUIP, ERGO SOLUTIONS, WORK LONGER AND MORE COMFORTABLY.  
EQUIP ERGO SOLUTIONS ARE PREMIUM OFFICE SETUPS THAT ARE  
COHESIVE, WORKING WELL IN ANY OFFICE ENVIRONMENT.**



# EQUIP HOME AND OFFICE



## ERGO 3 WAY ELECTRIC SIT-STAND DESK FRAME

The equip® ERGO Electric Sit-Stand Desk Frame creates your own desk space that lets you stand up during the long workday with an electric height adjustable frame. Periodically standing throughout the day can help relieve tension on the neck, back, and shoulders, as well as increase blood flow and reduce stress.

Enjoy being able to stand up in seconds with this sturdy frame featuring a dual motor lift system for smooth height transitions, telescopic height adjustment for ideal ergonomic viewing, touch control for customizable settings and convenience, and solid leg support for desk surfaces weighing up to 100kg.



Take your  
**work**  
to new  
heights





## ERGO 3 WAY ELECTRIC SIT-STAND DESK FRAME

Product N° - GREY 650803 | WHITE 650804 | BLACK 650805

### KEY FEATURES

- Max. Load Capacity: 125Kg
- Height adjustable between 62 and 128 cm
- 3-Stage Dual Motors
- Easy-to-use press controller makes height adjustment easy
- Thermal and overload protected
- Strong lifting power with low noise level
- Adjustable width fits a variety of desktop shapes and sizes
- Built-in Cable management
- Desktop table is NOT included
- Desktop table suggestion size: L x W (1100~2200) x (700~1000)mm
- Desktop table thickness suggestion 18mm

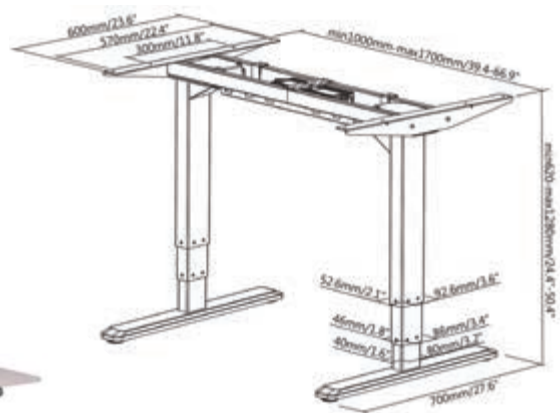

## ERGO L SHAPED ELECTRIC SIT-STAND DESK FRAME, TRIPLE MOTOR

Product N° - GREY 650820 | WHITE 650821

### KEY FEATURES

- 3-Leg Desk Frame: perfect for corner area
- Digital LED Memory Controller: For customizable settings
- Multiple Motors: offer heavier lifting ability and increased stability
- 3 Programmable Memory: presets save your desired height
- Sit/Stand Time Reminder: for regular movement
- Collision Avoidance System: safeguards against accidents and injuries
- Motor(s) is(are) Thermal and Overload Protected: for safety and longevity
- Switched Mode Power Supply: for energy and power efficiency
- Cable Management: keeps everything organized
- Adjustable Width: fits a variety of desktop shapes and sizes
- Three Stage Standard Column: offers more adjustability"
- Desktop table is NOT included
- Desktop table suggestion size: L X W (one side: 1400mm & one side:1800mm) x (700 x 800)mm
- Desktop table thickness suggestion 18mm

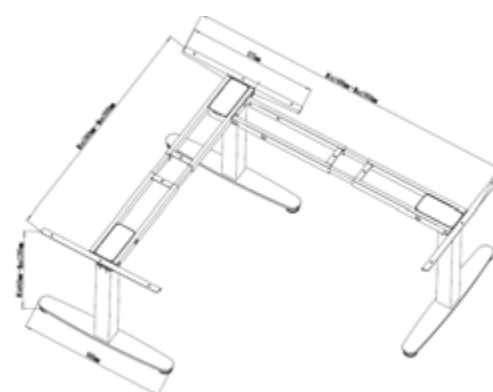

INSTALLATION VIDEO  
SCAN HERE:

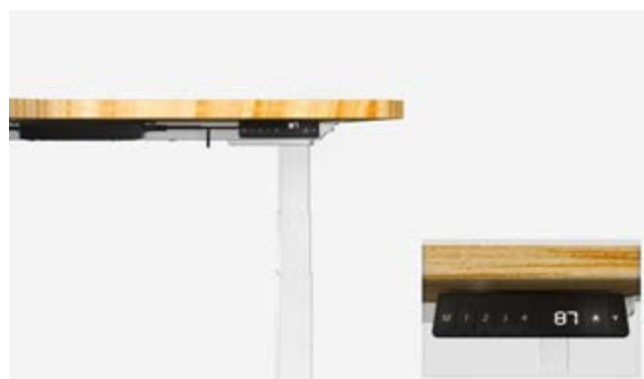





## ERGO ELECTRIC SIT-STAND DESK FRAME WITH DESKTOP

Product N° - GREY 650811 | BLACK 650812

### KEY FEATURES

- Max. Load Capacity: 70Kg
- Height adjustable between 68 ~118 cm
- Single Motor
- Easy-to-use press controller makes height adjustment easy
- Thermal and overload protected
- Strong lifting power with low noise level
- Built-in Cable management
- Desktop included
- Desktop size: L x W = 120 x 60cm

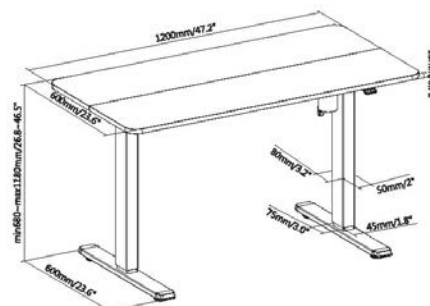

INSTALLATION VIDEO  
SCAN HERE:



## SPINE CABLE ORGANIZER

Product N° - BLACK 650808 | WHITE 650809  
GREY 650860

### KEY FEATURES

- Snap-together interlink blocks with 7" diameter steel base plate
- Come with top hooking element to screw under top surface
- Material: ABS



INSTALLATION VIDEO  
SCAN HERE:



## DOUBLE-CHANNEL CABLE MANAGEMENT SPINE

Product N° - BLACK 650861 | SILVER 650862

### KEY FEATURES

- Cable Organizer & Hider: keep cables concealed and protect cables from the wear and tear
- Double-Channel System: enables the separation of cords
- Modular Vertebrae Structure
- Weighted Base with Iron Block: offers extra stability
- Easy Setup: tools-free assembly in minutes, no expert installation required
- Material: ABS



INSTALLATION VIDEO  
SCAN HERE:



## CABLE MANAGEMENT ORGANIZER

Product N° 650863

### KEY FEATURES

- Simple Design: hides wire and power cords for a clean workspace.
- Easy installation: screw mounted or sit stand desk hanging type allows for quick installation.
- Free move: wire management allows for sit stand desktop movement while preventing damage to cabling.



INSTALLATION VIDEO  
SCAN HERE:



## MAGNETIC CABLE MANAGEMENT CHANNEL

Product N° - GREY 650864 | BLACK 650865

### KEY FEATURES

- Strong magnetic attachment
- Magnetic Cable Management Channel
- Cable Management: keeps everything organized



INSTALLATION VIDEO  
SCAN HERE:



## COILED CABLE TUBE SLEEVE

Product N° - 650867 1.0M  
650868 2.5M

### KEY FEATURES

- 20mm/1" Diameter Coiled Tube Cable Sleeve
- Cable Organizer & Hider: keep cables concealed and protect cables from the wear and tear
- Expandable Bundler: expands to fit a wide variety of cable gauges, ranging from thin phone chargers to thick power plugs
- Easy Setup: tools-free assembly in minutes, no expert installation required





## MULTIFUNCTIONAL CPU HOLDER

Product N° - 650890

### KEY FEATURES

- Steel Construction with strength and durability
- Max. VESA: 100x100
- Max. Load Capacity: 5Kg
- VESA Compatible: supports with standard
- VESA holes Increased storage room beneath the desktop 3-way installation: Clamped to the Pole / VESA Plate / Under Desktop

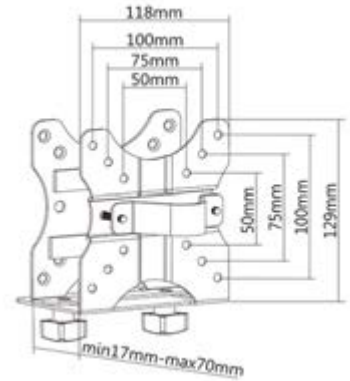

### 3 WAY INSTALLATION



Clamped to the pole

VESA Plate

Under Desktop

INSTALLATION VIDEO  
SCAN HERE:



## CPU UNDER DESK MOUNT BRACKET

Product N° - 650892

### KEY FEATURES

- Steel Construction with strength and durability
- 360° Swivel
- Easy-Glide Sliding Under-Desk Installation to saves more space
- Height Range: 300-533mm (11.8"-21")
- Depth Range: 88-203mm (3.5"-8")

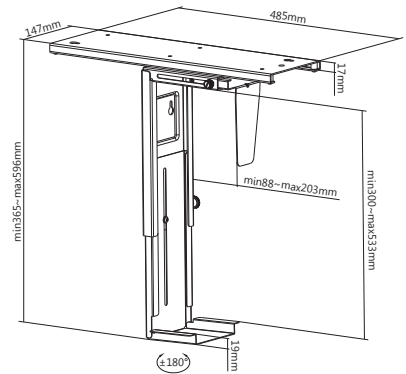

INSTALLATION VIDEO  
SCAN HERE:





# MONITOR DESK MOUNT SOLUTIONS



## 13"-32" ARTICULATING MONITOR DESK MOUNT BRACKET

Product N° - 650151

### KEY FEATURES

- Max. Load Capacity: 8Kg
- Max. VESA: 100x100
- Installation: Grommet and Clamp
- Height adjustment
- Full motion mount
- Cable clips keep cables organized and protected
- VESA standards compliant

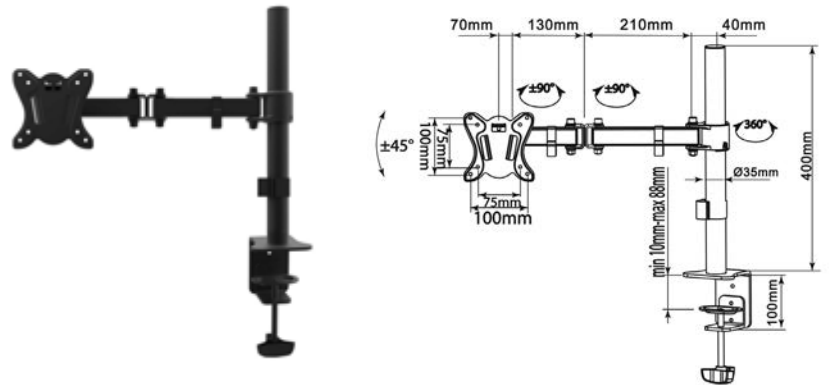

INSTALLATION VIDEO  
SCAN HERE:



## 13"-27" ARTICULATING DUAL MONITOR DESK MOUNT BRACKET

Product N° - 650152

### KEY FEATURES

- Max. Loading Capacity: 8Kg (per screen)
- Max. VESA: 100x100
- Installation: Grommet and Clamp
- Height adjustment
- Full motion mount
- Cable clips keep cables organized and protected
- VESA standards compliant
- Screen Rotation: 360°

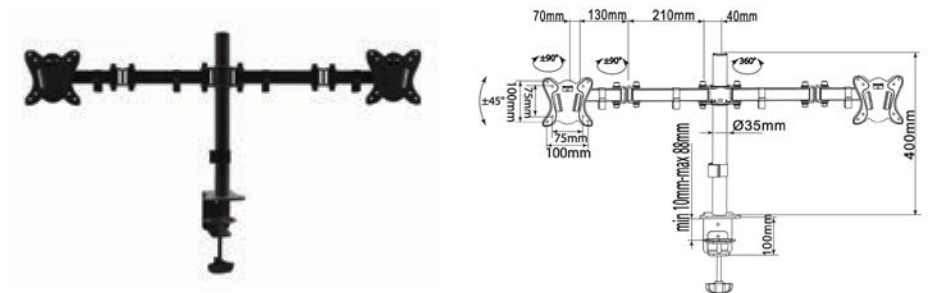

INSTALLATION VIDEO  
SCAN HERE:



## 17"-32" ARTICULATING MONITOR DESK MOUNT BRACKET, BLACK

Product N° - 650156

### KEY FEATURES

- Max. Load Capacity: 9Kg
- Max. VESA: 100x100
- Mounting Option: Clamp (10-85mm) / Grommet (10-40mm)
- Screen Rotation: 360°
- Height adjustment
- Full motion mount
- Cable clips keep cables organized and protected
- VESA standards compliant
- Slide-in VESA plate provides easy access for attachment and detachment

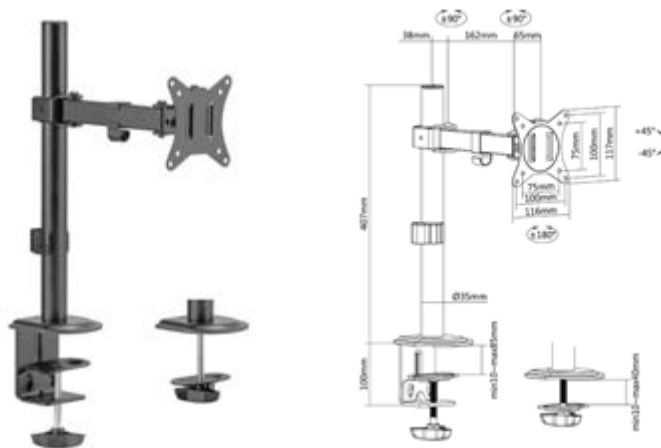

INSTALLATION VIDEO  
SCAN HERE:



## 17"-32" ARTICULATING MONITOR DESK MOUNT BRACKET, WHITE

Product N° - 650166

NEW

### KEY FEATURES

- Max. Load Capacity: 9Kg
- Max. VESA: 100x100
- Mounting Option: Clamp (10-85mm) / Grommet (10-40mm)
- Screen Rotation: 360°
- Height adjustment
- Full motion mount
- Cable clips keep cables organized and protected
- VESA standards compliant
- Slide-in VESA plate provides easy access for attachment and detachment

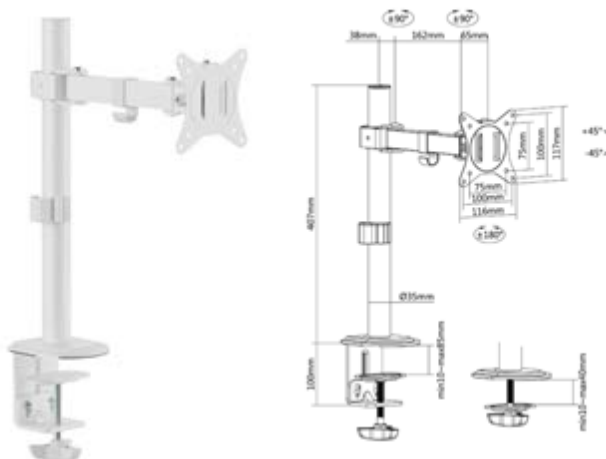

INSTALLATION VIDEO  
SCAN HERE:





## 17"-32" ARTICULATING DUAL MONITOR DESK MOUNT BRACKET, BLACK

Product N° - 650157

### KEY FEATURES

- Max. Load Capacity: 9kg (per screen)
- Max. VESA: 100x100
- Installation: Grommet and Clamp
- Screen Rotation: 360°
- Mounting Option: Clamp/Grommet
- Full motion mount
- Cable clips keep cables organized and protected
- Height adjustment
- VESA standards compliant
- Free-tilting design for multiple monitor viewing angles
- Detachable VESA Plate Design
- Portrait or Landscape viewing : fits any installation

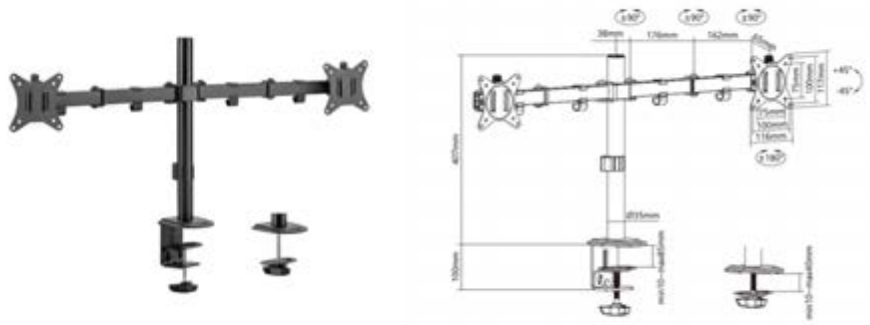

INSTALLATION VIDEO  
SCAN HERE:



## 17"-32" ARTICULATING DUAL MONITOR DESK MOUNT BRACKET, WHITE

Product N° - 650167



### KEY FEATURES

- Max. Load Capacity: 9kg (per screen)
- Max. VESA: 100x100
- Installation: Grommet and Clamp
- Screen Rotation: 360°
- Mounting Option: Clamp/Grommet
- Full motion mount
- Cable clips keep cables organized and protected
- Height adjustment
- VESA standards compliant
- Free-tilting design for multiple monitor viewing angles
- Detachable VESA Plate Design
- Portrait or Landscape viewing : fits any installation

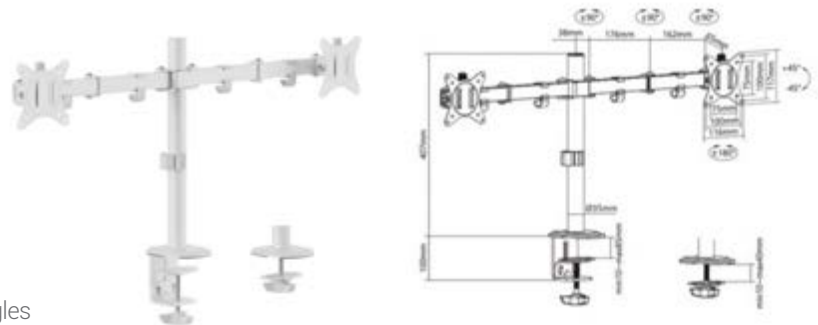

INSTALLATION VIDEO  
SCAN HERE:



## 13"-27" ARTICULATING DUAL MONITOR DESK MOUNT BRACKET

Product N° - 650115

### KEY FEATURES

- Max. Loading Capacity: 8Kg (per screen)
- Max. VESA: 100x100
- Installation: Grommet and Clamp
- Screen Rotation: 360°
- Mounting Option: Clamp/Grommet
- Full motion mount
- Cable clips keep cables organized and protected
- Height adjustment
- VESA standards compliant

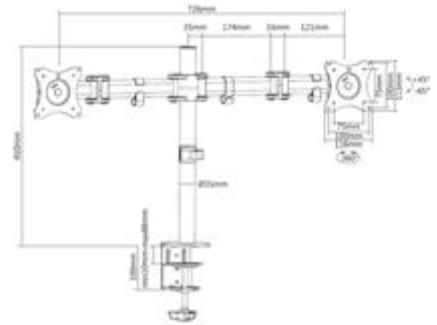

INSTALLATION VIDEO  
SCAN HERE:



## 17"-32" ARTICULATING TRIPLE MONITOR DESK MOUNT BRACKET

Product N° - 650158

### KEY FEATURES

- Max. Load Capacity: 7Kg (per screen)
- Max. VESA: 75x75, 100x100
- Sturdy Steel Construction
- Individual VESA Plate Height Adjustment.
- Portrait and Landscape Orientation
- Free-Tilting Design
- Cable clips keep cables organized and protected
- Detachable VESA Plate Design: enables easy installation

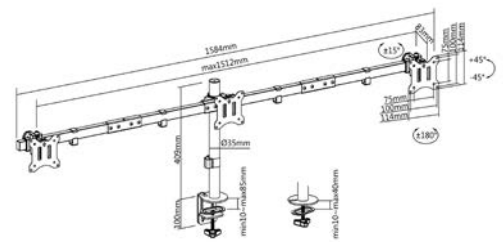

INSTALLATION VIDEO  
SCAN HERE:



## 17"-32" ARTICULATING QUAD MONITOR DESK MOUNT BRACKET

Product N° - 650159

### KEY FEATURES

- Max. Load Capacity: 9Kg (per screen)
- Max. VESA: 100x100
- Screen Rotation: 360°
- Mounting Option: Clamp (10-85mm) /Grommet (10-40mm)
- Swivel and Tilt Desk Mount
- VESA standards compliant
- Cable clips keep cables organized and protected
- Both grommet and desk clamp mounting available
- Freely adjusting height for an optimal ergonomic position
- Slide-in VESA plate provides easy access for attachment and detachment

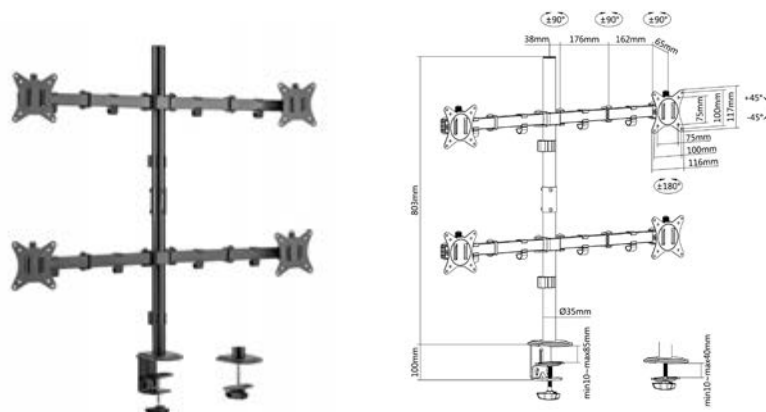

INSTALLATION VIDEO  
SCAN HERE:



## 17"-32" ARTICULATING 6 MONITOR DESK MOUNT BRACKET

Product N° - 650160

### KEY FEATURES

- Max. Load Capacity: 7Kg (per screen)
- Max. VESA: 75x75, 100x100
- Sturdy Steel Construction
- Individual VESA Plate Height Adjustment.
- Portrait and Landscape Orientation
- Free-Tilting Design
- Cable clips keep cables organized and protected
- Detachable VESA Plate Design: enables easy installation

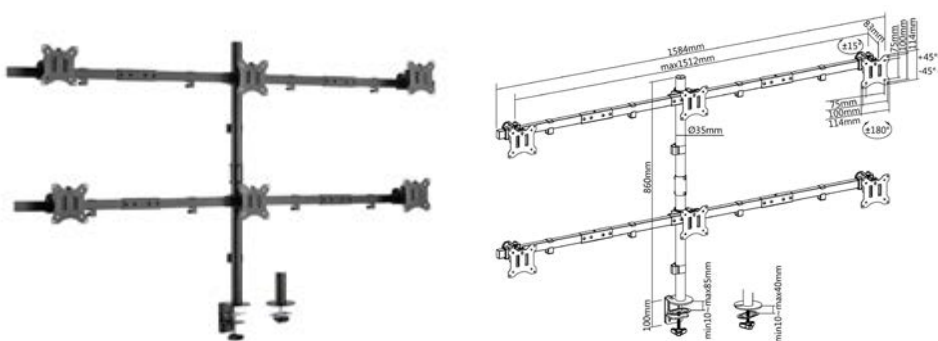

INSTALLATION VIDEO  
SCAN HERE:



## 17"-32" INTERACTIVE MONITOR DESK MOUNT BRACKET

Product N° - 650120

### KEY FEATURES

- Max. Load Capacity: 9Kg
- Max. VESA: 100x100
- Screen Rotation: 360°
- Mounting Option: Clamp/Grommet
- Gas spring structure offers perfect counterbalance presentation in all directions
- Built-in Cable management
- Both grommet and desk clamp mounting available
- VESA standards compliant

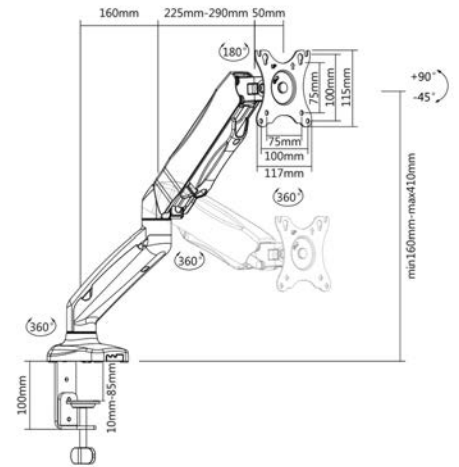

INSTALLATION VIDEO  
SCAN HERE:



## 17"-32" INTERACTIVE DUAL MONITOR DESK MOUNT BRACKET

Product N° - 650121

### KEY FEATURES

- Max. Load Capacity: 9Kg (per screen)
- Max. VESA: 100x100
- Screen Rotation: 360°
- Mounting Option: Clamp/Grommet
- Gas spring structure offers perfect counterbalance presentation in all directions
- Built-in Cable management
- Both grommet and desk clamp mounting available
- VESA standards compliant

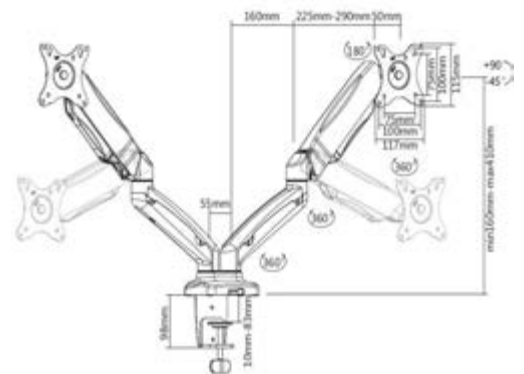

INSTALLATION VIDEO  
SCAN HERE:





## 13"-27" ARTICULATING MONITOR DESK MOUNT BRACKET

Product N° - 650112

### KEY FEATURES

- Max. Load Capacity: 9Kg
- Max. VESA: 100x100
- Mounting Option: Clamp/Grommet
- Screen Rotation: 360°
- Sturdy and lightweight aluminum construction
- Gas spring structure offers perfect counterbalance presentation in all directions
- VESA standards compliant
- Tool-free height adjustment
- Integrated cable management system
- Built-in spring tension gauge can be easily adjusted to fit varied weights on the arm

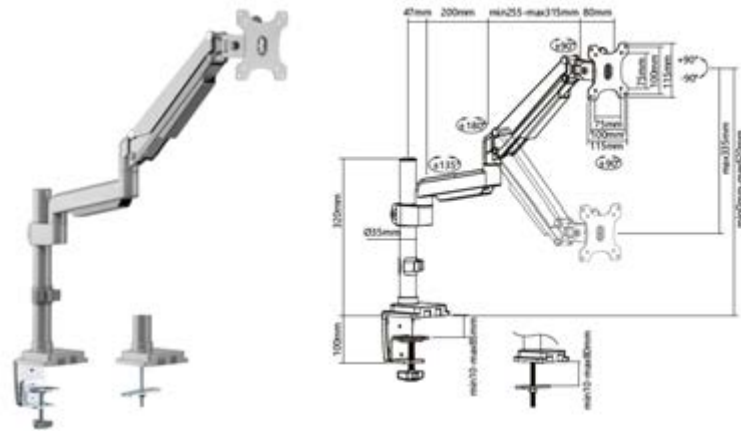







# MONITOR WALL MOUNT SOLUTIONS



## 17"-32" SINGLE MONITOR WALL-MOUNTED BRACKET, ARM LENGTH:290MM

Product N° - 650136

### KEY FEATURES

- Max. Load Capacity: 9Kg
- Max. VESA: 100x100
- Screen Rotation: 360°
- Gas spring structure offers perfect counterbalance presentation in all directions
- Built-in spring tension gauge can be easily adjusted to fit varied weights on the arm
- VESA standards compliant
- Free-tilting design for multiple monitor viewing angles
- Slide-in wall plate provides easy access for attachment and detachment
- Cable clips keep cables organized and protected

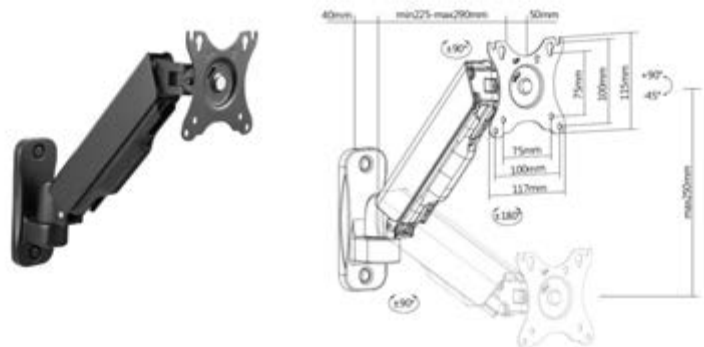

INSTALLATION VIDEO  
SCAN HERE:







## LAPTOP HOLDER FOR 10"-15.6"

Product N° - 650155

### KEY FEATURES

- Mountable on VESA standards compliant 75x75 & 100x100
- Ventilated Design
- Width Adjustment
- Steel Construction with strength and durability

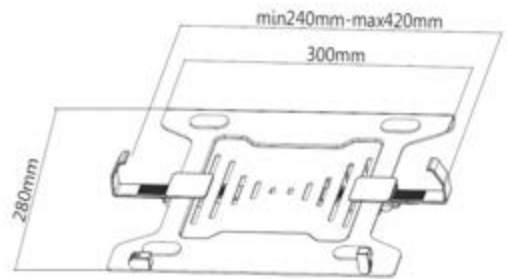

## 13"-32" ARTICULATING DUAL ARM MONITOR LAPTOP DESK MOUNT BRACKET

Product N° - 650119

### KEY FEATURES

- Max. Load Capacity: 8Kg
- Max. VESA: 100x100
- Screen Rotation: 360°
- Mounting Option: Clamp/Grommet
- VESA standards compliant
- Built-in Cable management
- Both grommet and desk clamp mounting available

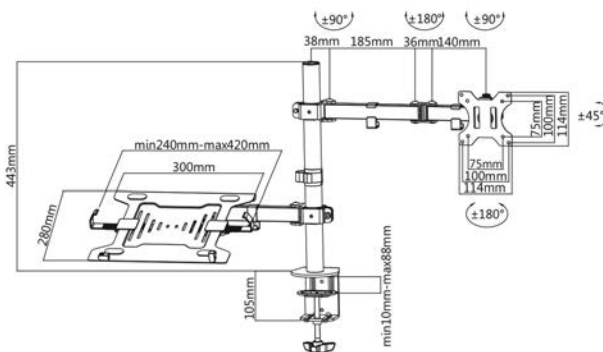

INSTALLATION VIDEO  
SCAN HERE:







# PREMIUM DESK MOUNT SOLUTIONS





## 17"-32" DUAL MONITOR DESK MOUNT BRACKET

Product N° -650161

### KEY FEATURES

- Max. Load Capacity: 9Kg (per screen)
- Max. VESA: 75x75, 100x100
- Gas Spring-Assisted Monitor Arm
- Easy-Grip Handle: makes pull-down and placement a snap
- Sliding Horizontal Monitor Bar:
- Cable clips keep cables organized and protected
- Detachable VESA Plate Design: enables easy installation

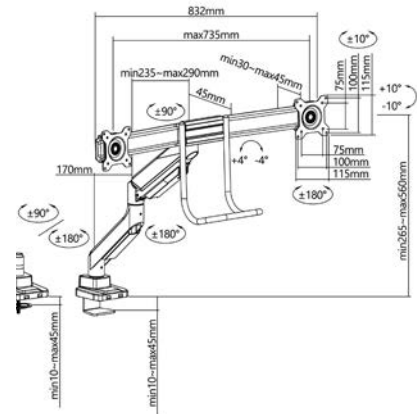

INSTALLATION VIDEO  
SCAN HERE:



## 17"-32" TRIPLE MONITOR DESK MOUNT BRACKET

Product N° - 650162

### KEY FEATURES

- Max. Load Capacity: 6Kg (per screen)
- Max. VESA: 75x75, 100x100
- Gas Spring-Assisted Monitor Arm
- Easy-Grip Handle: makes pull-down and placement a snap
- Sliding Horizontal Monitor Bar:
- Cable clips keep cables organized and protected
- Detachable VESA Plate Design: enables easy installation

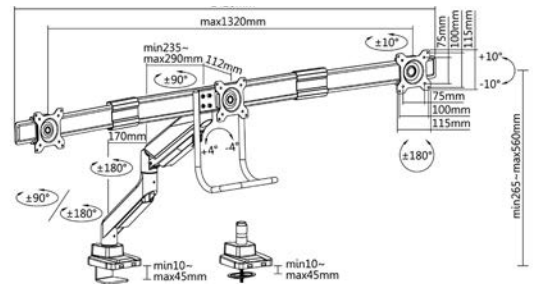

INSTALLATION VIDEO  
SCAN HERE:



## 17"-49" HEAVY-DUTY MONITOR DESK MOUNT BRACKET, BLACK

Product N° -650180

### KEY FEATURES

- Max. Load Capacity: 20Kg
- Max. VESA: 75x75, 100x100
- Gas Spring-Assisted Monitor Arm
- Optimized Tilting Structure
- Installs from Top Side: installs entirely from above the desk surface
- Cable clips keep cables organized and protected
- Detachable VESA Plate Design: enables easy installation

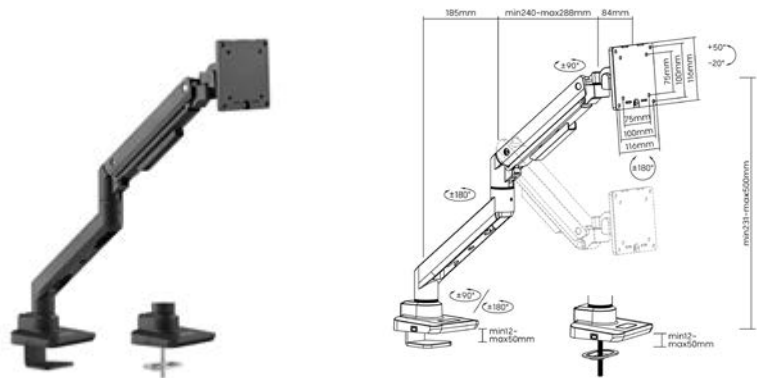

INSTALLATION VIDEO  
SCAN HERE:



## 17"-49" HEAVY-DUTY MONITOR DESK MOUNT BRACKET, WHITE

Product N° - 650181

### KEY FEATURES

- Max. Load Capacity: 20Kg
- Max. VESA: 75x75, 100x100
- Gas Spring-Assisted Monitor Arm
- Optimized Tilting Structure
- Installs from Top Side: installs entirely from above the desk surface
- Cable clips keep cables organized and protected
- Detachable VESA Plate Design: enables easy installation

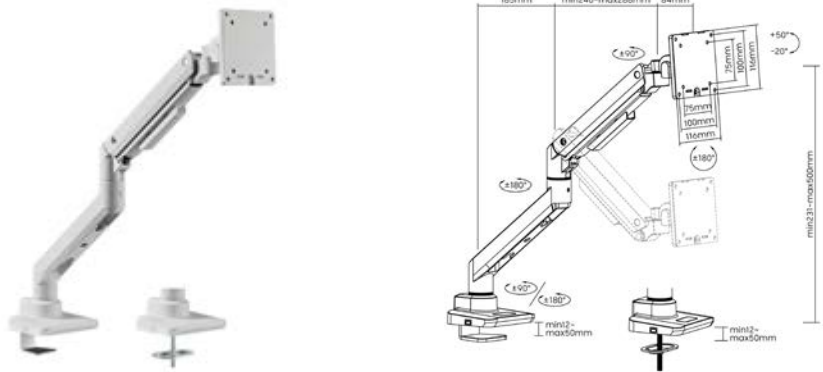

INSTALLATION VIDEO  
SCAN HERE:



## 17"-35" HEAVY-DUTY DUAL MONITOR DESK MOUNT BRACKET, BLACK

Product N° -650182

### KEY FEATURES

- Max. Load Capacity: 20Kg (per screen)
- Max. VESA: 75x75, 100x100
- Gas Spring-Assisted Monitor Arm
- Optimized Tilting Structure
- Installs from Top Side: installs entirely from above the desk surface
- Cable clips keep cables organized and protected
- Detachable VESA Plate Design: enables easy installation

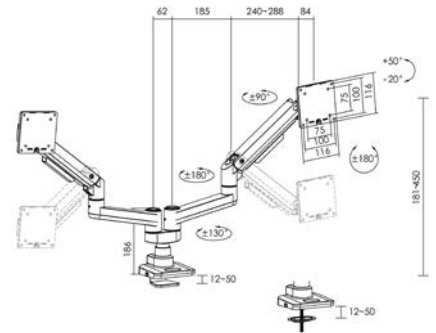

INSTALLATION VIDEO  
SCAN HERE:



## 17"-35" HEAVY-DUTY DUAL MONITOR DESK MOUNT BRACKET, WHITE

Product N° - 650183

### KEY FEATURES

- Max. Load Capacity: 20Kg (per screen)
- Max. VESA: 75x75, 100x100
- Gas Spring-Assisted Monitor Arm
- Optimized Tilting Structure
- Installs from Top Side: installs entirely from above the desk surface
- Cable clips keep cables organized and protected
- Detachable VESA Plate Design: enables easy installation

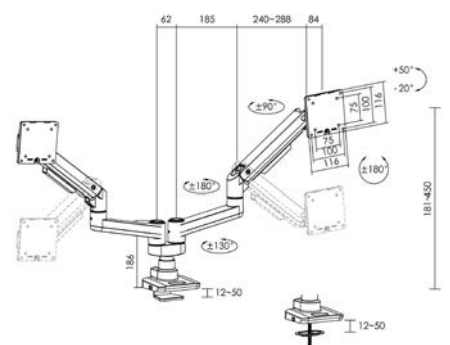

INSTALLATION VIDEO  
SCAN HERE:



## 17"-35" PREMIUM MONITOR DESK MOUNT BRACKET, BLACK

Product N° -650184

### KEY FEATURES

- Max. Load Capacity: 10.5Kg
- Max. VESA: 75x75, 100x100
- Gas Spring-Assisted Monitor Arm
- Easy to adjust, no tools required
- 180° Rotation Stop
- Built-in Spring Tension Mechanism: for perfect weight adjustments
- Cable clips keep cables organized and protected
- Detachable VESA Plate Design: enables easy installation

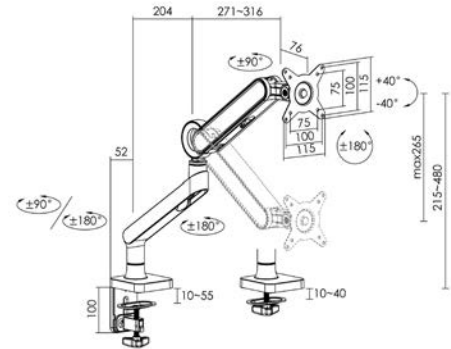

INSTALLATION VIDEO  
SCAN HERE:



## 17"-35" PREMIUM MONITOR DESK MOUNT BRACKET, WHITE

Product N° - 650185

### KEY FEATURES

- Max. Load Capacity: 10.5Kg
- Max. VESA: 75x75, 100x100
- Gas Spring-Assisted Monitor Arm
- Easy to adjust, no tools required
- 180° Rotation Stop
- Built-in Spring Tension Mechanism: for perfect weight adjustments
- Cable clips keep cables organized and protected
- Detachable VESA Plate Design: enables easy installation

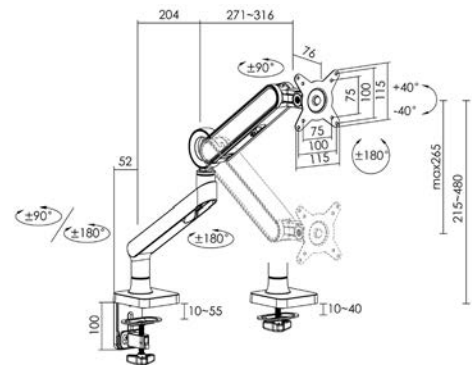

INSTALLATION VIDEO  
SCAN HERE:









# MONITOR STAND SOLUTIONS



## 13"-32" ARTICULATING MONITOR TABLETOP STAND

Product N° - 650122

### KEY FEATURES

- Max. Load Capacity: 8Kg
- Max. VESA: 100x100
- Screen Rotation: 360°
- Built-in Cable management
- Freely adjusting height for an optimal ergonomic position
- VESA standards compliant

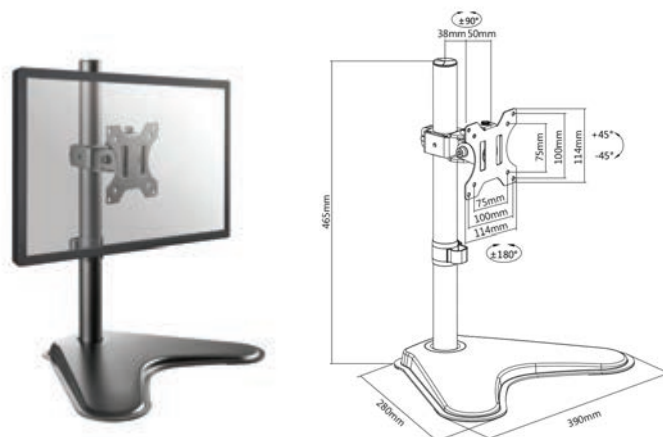

INSTALLATION VIDEO  
SCAN HERE:



## 17"-32" FREE-STANDING MONITOR STAND

Product N° - 650126

### KEY FEATURES

- Max. Load Capacity: 8Kg
- Max. VESA: 100x100
- Screen Rotation: 360°
- VESA standards compliant
- Built-in Cable management
- 10 Height Settings: for optimal viewing height (Max. 540mm)
- Freely adjusting height for an optimal ergonomic position
- Non-skid Silicone Pads
- Slide-in VESA plate provides easy access for attachment and detachment

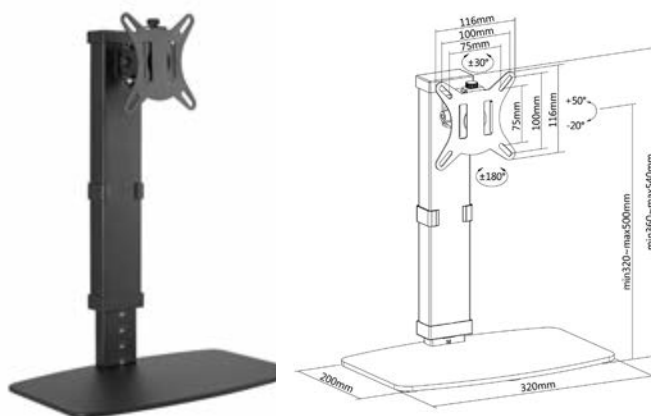

INSTALLATION VIDEO  
SCAN HERE:









## 17"-27" ARTICULATING TRIPLE MONITOR TABLETOP STAND

Product N° - 650125

### KEY FEATURES

- Max. Load Capacity: 8Kg (per screen)
- Max. VESA: 100x100
- Screen Rotation: 360°
- Freely adjusting height for an optimal ergonomic position
- Free-tilting design for multiple monitor viewing angles
- Detachable VESA Plate Design

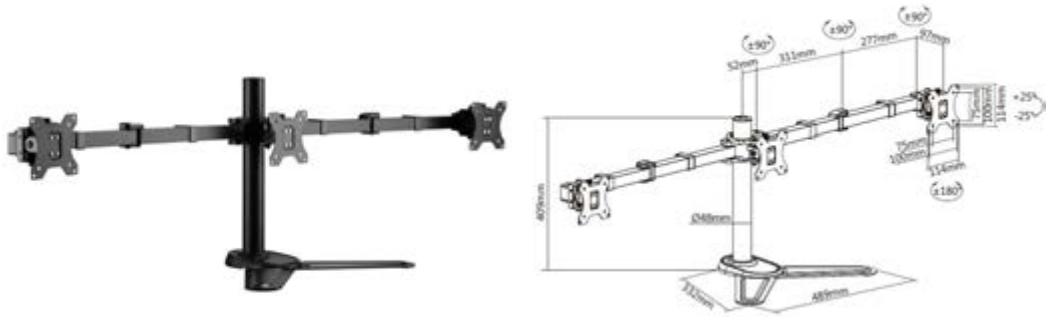

INSTALLATION VIDEO  
SCAN HERE:



## 17"-32" ARTICULATING QUAD MONITOR TABLETOP STAND

Product N° - 650127

### KEY FEATURES

- Max. Load Capacity: 9Kg (per screen)
- Max. VESA: 100x100
- Screen Rotation: 360°
- Freely adjusting height for an optimal ergonomic position
- Free-tilting design for multiple monitor viewing angles
- Slide-in VESA plate provides easy access for attachment and detachment
- Portrait or Landscape Viewing: one solution fits any installation
- Built-in Cable management

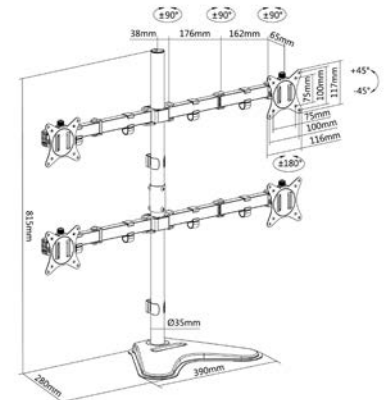

INSTALLATION VIDEO  
SCAN HERE:



## DESKTOP MONITOR STAND

Product N° - 650880

### KEY FEATURES

- Max. Load Capacity: 20Kg
- Increased storage room beneath the desktop
- Non-skid Silicone Pads
- Raise your monitor to viewing comfort

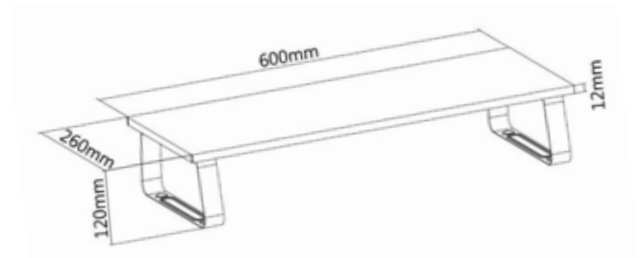

## DESKTOP MONITOR STAND WITH USB

Product N° - 650881

### KEY FEATURES

- Max. Load Capacity: 15Kgs
- Increased storage room beneath the desktop
- Non-skid Silicone Pads
- Raise your monitor to viewing comfort
- with 3 x USB 2.0 ports
- With integrated smartphone holder

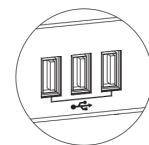
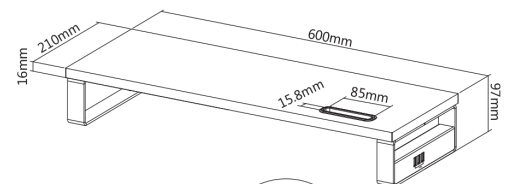

## GLASS DESKTOP MONITOR STAND

Product N° - 650882

NEW

### KEY FEATURES

- Universal Tabletop Monitor Riser
- Ergonomic Design: elevate the screen to eye level for better viewing angle
- Increased storage room on the desktop
- Non-skid Silicone Pads: protect work surface from scratches or scuffs
- Max. Load Capacity: 20Kg



INSTALLATION VIDEO  
SCAN HERE:



## ERGONOMIC SIT/STAND RISER

Product N° - 650840

### KEY FEATURES

- Adjustable height for perfect ergonomic positioning
- High-Strength and impact resistant MDF board quality
- Max. loading capacity: 15kgs
- High adjustment between 10~50cm
- Desktop thickness: 15mm
- Lower platform for mouse and keyboard
- With integrated holder for smartphone & tablet

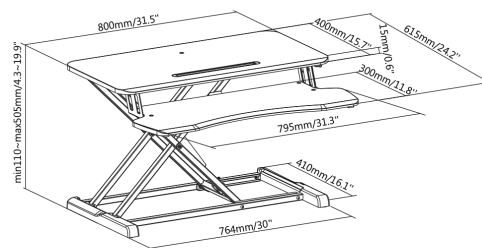

INSTALLATION VIDEO  
SCAN HERE:





# WORKSTATION SOLUTIONS





## 17"-32" SINGLE MONITOR WALL-MOUNTED WORKSTATION

Product N° - 650170

### KEY FEATURES

- Max. Load Capacity: 8Kg
- Keyboard Tray Weight: 1kg
- Max. VESA: 75x75,100x100
- Counter-Balance Gas Spring
- Detachable VESA Plate Design
- Cable clips keep cables organized and protected
- Full-Motion Mechanism
- Upgraded Keyboard Tray: provides comfort for your wrists

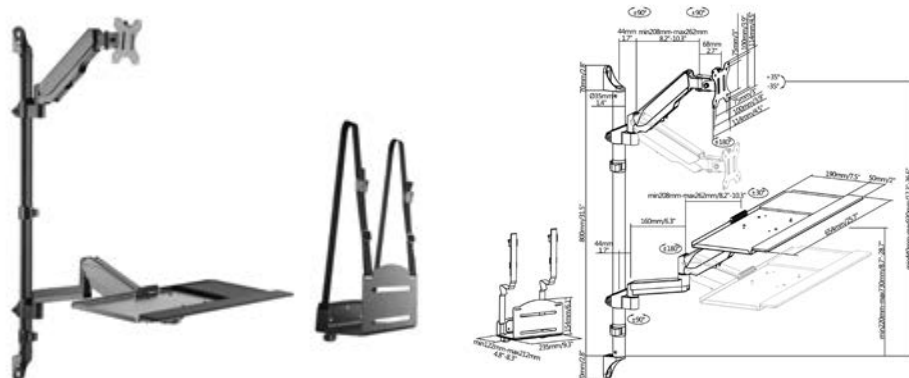

INSTALLATION VIDEO  
SCAN HERE:



## 17"-32" SINGLE MONITOR MOBILE WORKSTATION

Product N° - 650171

### KEY FEATURES

- Max. Load Capacity: 8Kg
- Keyboard Tray Weight: 2kg
- Max. VESA: 75x75,100x100
- Detachable VESA Plate Design: enables easy installation
- Upgraded Keyboard Tray: provides comfort for your wrists
- Heavy-Duty Casters:

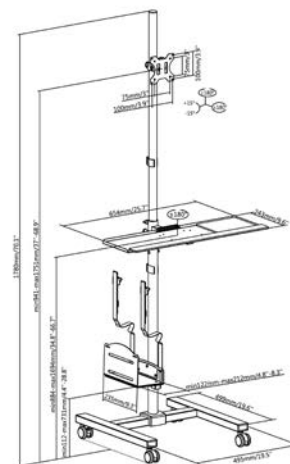

INSTALLATION VIDEO  
SCAN HERE:





## TV MOUNT SOLUTIONS

**THE EQUIP<sup>®</sup> TV WALL MOUNT BRACKET IS A COMPACT BUT STURDY PRODUCT THAT ENSURES A RELIABLE INSTALLATION OF YOUR LCD/PLASMA TV. FOLLOW THE GRAPHIC GUIDE INCLUDED IN THE PACKAGE, YOU CAN INSTALL YOUR TV ON YOUR OWN WITH EASE. THE WALL BRACKET FITS MOST OF THE WALL MATERIALS- BRICK, CONCRETE AND WOOD, MAKING THE IDEAL CHOICE FOR YOU TO SET UP YOUR SCREENS.**

## 23"-43" SLIM TV WALL MOUNT BRACKET

Product N° - 650401

### KEY FEATURES

- Max. Load Capacity: 25Kg
- Max. VESA: 200x200
- Ultra Slim profile for space saving
- Tool-free tilt adjustment
- VESA standards compliant

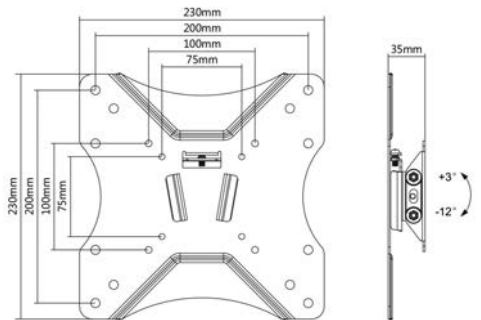

INSTALLATION VIDEO  
SCAN HERE:



## 23"-42" PIVOTING TV WALL MOUNT BRACKET

Product N° - 650402

### KEY FEATURES

- Max. Load Capacity: 25Kg
- Max. VESA: 200x200
- Adjustment knob enables a full range of tilt/swivel action
- VESA standards compliant
- Cable clips keep cables organized and protected

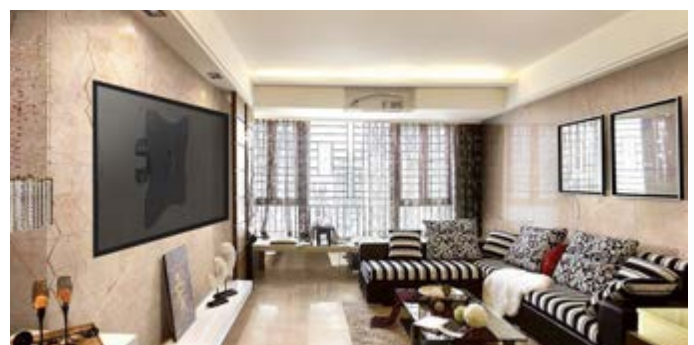
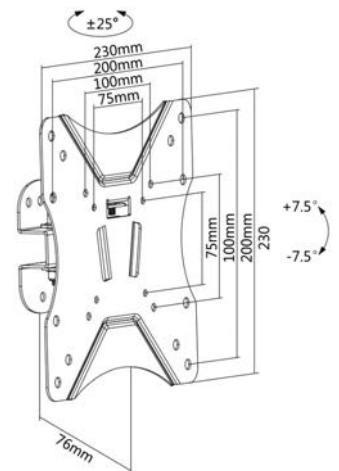

INSTALLATION VIDEO  
SCAN HERE:











## 23"-55" FULL MOTION TV WALL MOUNT BRACKET

Product N° - 650412

### KEY FEATURES

- Max. Load Capacity: 30Kg
- Max. VESA: 400x400
- Swivel and tilt wall mount
- Built-in Cable management
- VESA standards compliant
- Adjustment knob enables a full range of tilt action
- Cable clips keep cables organized and protected
- Free-tilting design for multiple monitor viewing angles



Dimensions (mm)

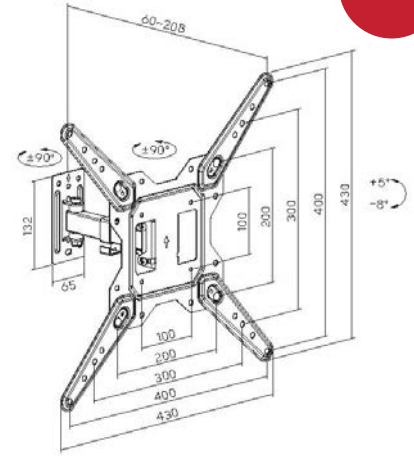

NEW



INSTALLATION VIDEO  
SCAN HERE:



## 23"-55" FULL MOTION TV WALL MOUNT BRACKET

Product N° - 650413

### KEY FEATURES

- Max. Load Capacity: 30Kg
- Max. VESA: 400x400
- Swivel and tilt wall mount
- Built-in Cable management
- VESA standards compliant
- Adjustment knob enables a full range of tilt action
- Cable clips keep cables organized and protected
- Free-tilting design for multiple monitor viewing angles



Dimensions (mm)

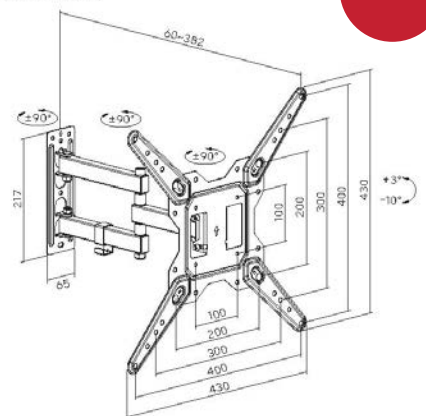

NEW



INSTALLATION VIDEO  
SCAN HERE:



### 37"-55" FIXED TV WALL MOUNT BRACKET

Product N° - 650363

**KEY FEATURES**

- Max. Load Capacity: 55Kg
- Max. VESA: 400 x 400
- Integrated bubble level assures easy installation alignment
- Slide-in wall plate provides easy access for attachment and detachment
- VESA standards compliant

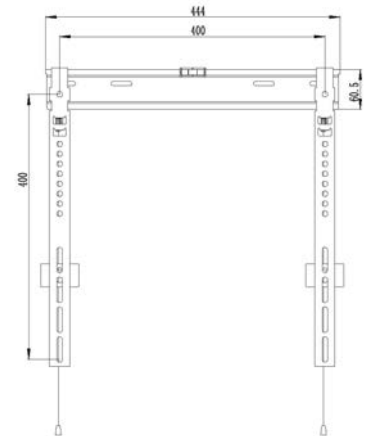

INSTALLATION VIDEO  
SCAN HERE:



### 32"-55" ECONOMY SLIM TILT TV WALL MOUNT BRACKET

Product N° - 650319

**KEY FEATURES**

- Max. Load Capacity: 35Kg
- Max. VESA: 400x400
- Free-tilting design for multiple monitor viewing angles
- Ultra Slim profile for space saving
- VESA standards compliant

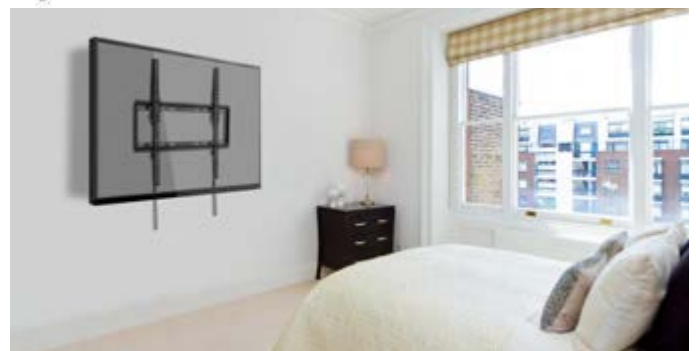
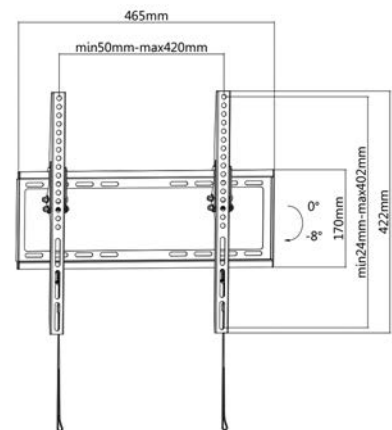

INSTALLATION VIDEO  
SCAN HERE:



### 32"-55" FIXED TV WALL MOUNT BRACKET

Product N° - 650310

**KEY FEATURES**

- Max. VESA: 400x400
- Max. Load Capacity: 40Kg
- Slide-in wall plate provides easy access for attachment and detachment
- Integrated bubble level assures easy installation alignment
- VESA standards compliant

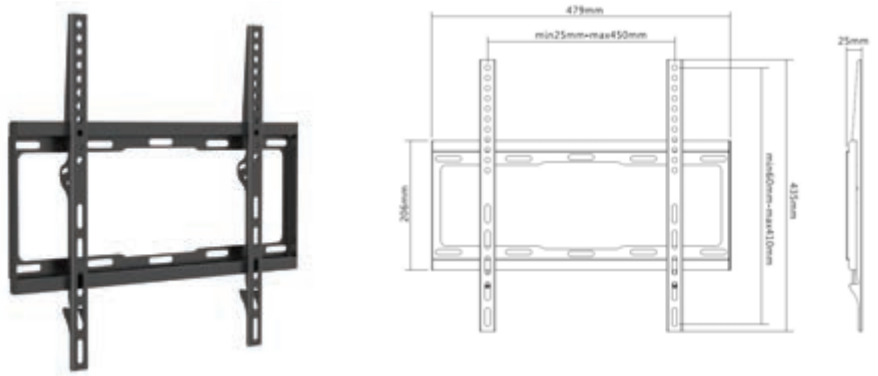

INSTALLATION VIDEO  
SCAN HERE:



### 32"-55" TILT TV WALL MOUNT BRACKET

Product N° - 650311

**KEY FEATURES**

- Max. Load Capacity: 35Kg
- Max. VESA: 400x400
- Free-tilting design for multiple monitor viewing angles
- Slide-in wall plate provides easy access for attachment and detachment
- Integrated bubble level assures easy installation alignment
- VESA standards compliant

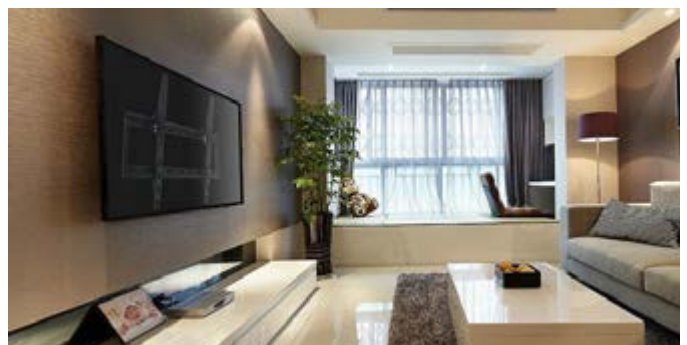
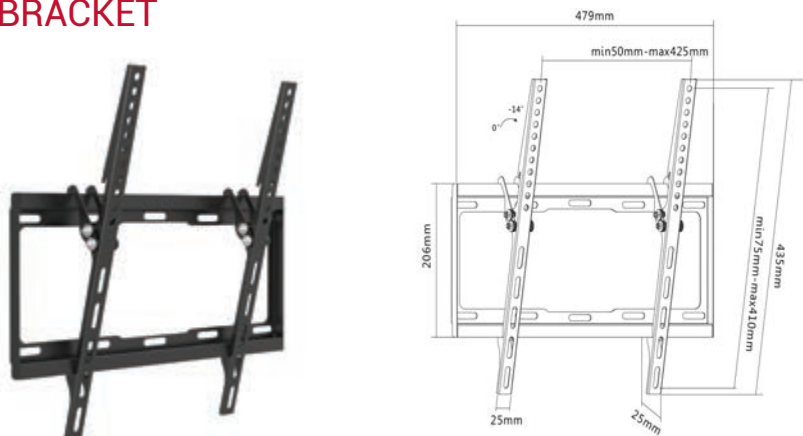

INSTALLATION VIDEO  
SCAN HERE:





### 37"-70" FIXED TV WALL BRACKET

Product N° - 650333

**KEY FEATURES**

- Max. Load Capacity: 35Kg
- Max. VESA: 600x400
- Ultra-slim design
- Slide-in wall plate provides easy access for attachment and detachment
- Integrated bubble level assures easy installation alignment
- VESA standards compliant

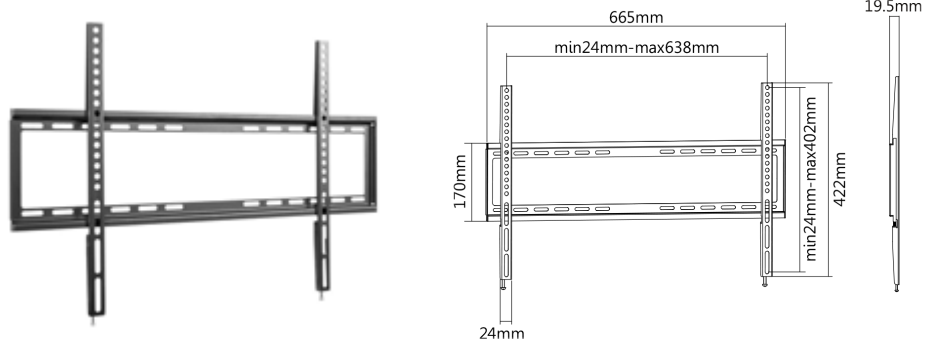

INSTALLATION VIDEO  
SCAN HERE:



### 37"-70" LOW PROFILE TV WALL MOUNT BRACKET

Product N° - 650334

**KEY FEATURES**

- Max. Load Capacity: 35Kg
- Max. VESA: 600x400
- Ultra-slim design
- Integrated bubble level assures easy installation alignment
- Adjustment knob enables a full range of tilt action
- Easy-grip button for quick angling and locking
- VESA standards compliant

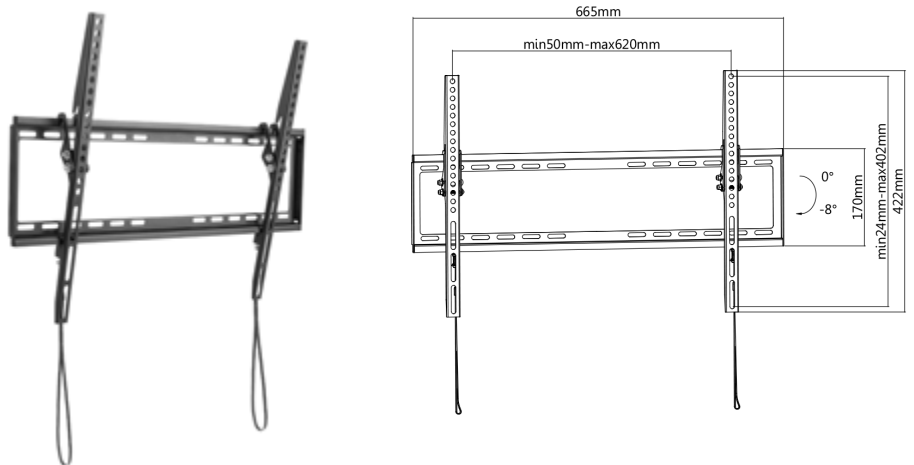

INSTALLATION VIDEO  
SCAN HERE:



### 37"-70" FIXED SLIM TV WALL MOUNT BRACKET

Product N° - 650330

**KEY FEATURES**

- Max. Load Capacity: 40Kg
- Max. VESA: 600x400
- Slide-in wall plate provides easy access for attachment and detachment
- Integrated bubble level assures easy installation alignment
- VESA standards compliant

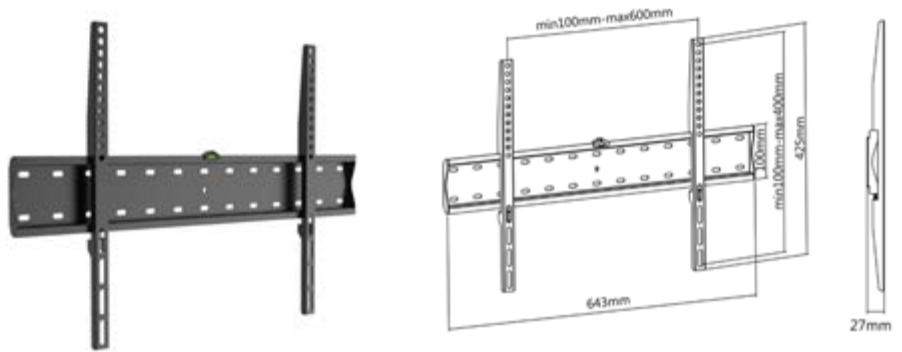

INSTALLATION VIDEO  
SCAN HERE:



### 37"-70" TILT TV WALL BRACKET

Product N° - 650332

**KEY FEATURES**

- Max. Load Capacity: 40Kg
- Max. VESA: 600x400
- Slide-in wall plate provides easy access for attachment and detachment
- Integrated bubble level assures easy installation alignment
- VESA standards compliant
- Free-tilting design for multiple monitor viewing angles

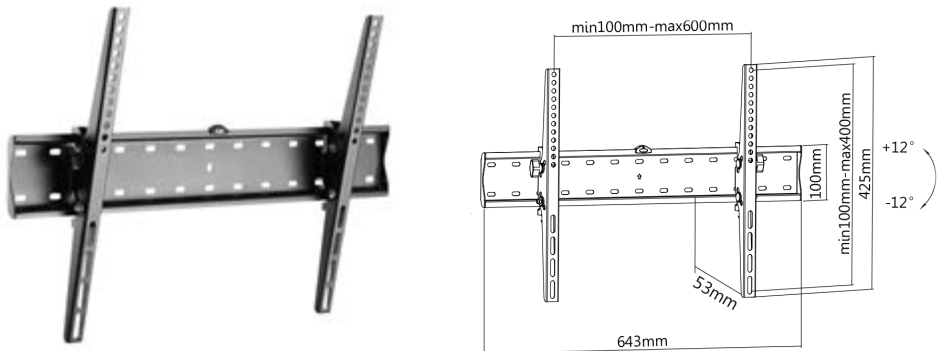

INSTALLATION VIDEO  
SCAN HERE:



## 60"-100" FIXED CURVED TV WALL MOUNT BRACKET

Product N° - 650323

### KEY FEATURES

- Max. Load Capacity: 100Kg
- Max. VESA: 900x600
- X-Large Heavy-duty Fixed Curved & Flat Panel TV Wall Mount
- Automatically click-in spring lock helps TV brackets snap into place
- VESA standards compliant

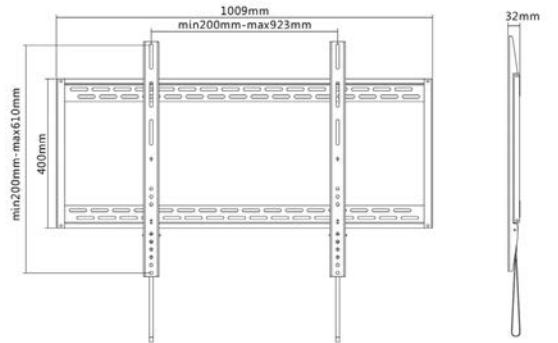

INSTALLATION VIDEO  
SCAN HERE:



## 60"-100" TILT CURVED TV WALL MOUNT BRACKET

Product N° - 650322

### KEY FEATURES

- Max. Load Capacity: 100Kg
- Max. VESA: 1000x800
- Free-tilting design for multiple monitor viewing angles
- Automatically click-in spring lock helps TV brackets snap into place
- Tool-free tilt adjustment
- VESA standards compliant

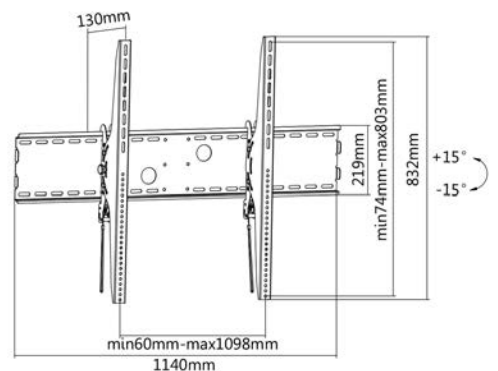

INSTALLATION VIDEO  
SCAN HERE:



## 60"-120" HEAVY-DUTY FIXED TV MOUNT BRACKET

Product N° - 650338

### KEY FEATURES

- Max. Load Capacity: 120Kg
- Max. VESA: 900x600
- Automatic Spring Locks with Quick Release Cords
- Heavy-Duty Steel Construction: provides extra strength and durability
- VESA standards compliant

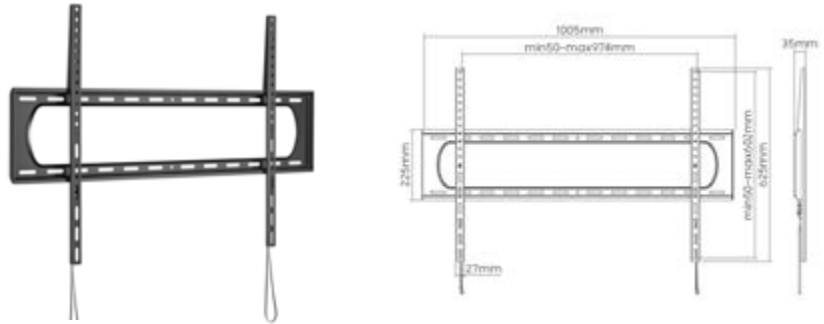

INSTALLATION VIDEO  
SCAN HERE:



## 60"-120" HEAVY-DUTY TILT TV MOUNT BRACKET

Product N° - 650339

### KEY FEATURES

- Max. Load Capacity: 120Kg
- Max. VESA: 900x600
- Automatic Spring Locks with Quick Release Cords
- Heavy-Duty Steel Construction: provides extra strength and durability
- Free-tilting design for multiple monitor viewing angles
- VESA standards compliant

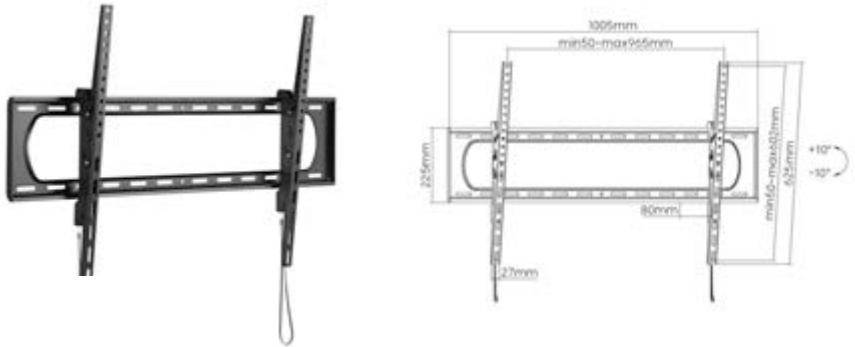

INSTALLATION VIDEO  
SCAN HERE:





## 43"-90" ULTRA-SLIM FULL MOTION TV WALL MOUNT BRACKET

Product N° - 650344



### KEY FEATURES

- Max. Load Capacity: 50Kg
- Max. VESA: 600x400
- Ultra-slim design
- Free-tilting design for multiple monitor viewing angles
- Swiveling Arm(s): offer(s) maximum viewing flexibility (makes every seat the best seat)
- Leveling adjustments: allow TV to be perfectly positioned after hanging
- Folding Design: saves space
- Decorative Covers: for a more elegant look
- Built-in Cable management
- VESA standards compliant

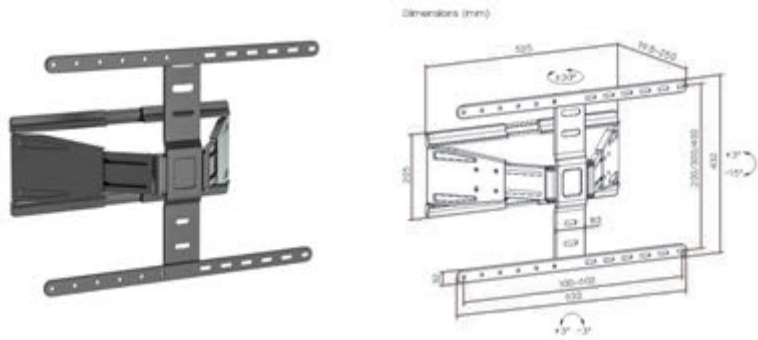

INSTALLATION VIDEO  
SCAN HERE:



### 32"-55" ARTICULATING TV WALL MOUNT BRACKET

Product N° - 650315

**KEY FEATURES**

- Max. Load Capacity: 50Kg
- Max. VESA: 400x400
- Full motion mount
- VESA standards compliant
- Level adjustment ensures perfect positioning

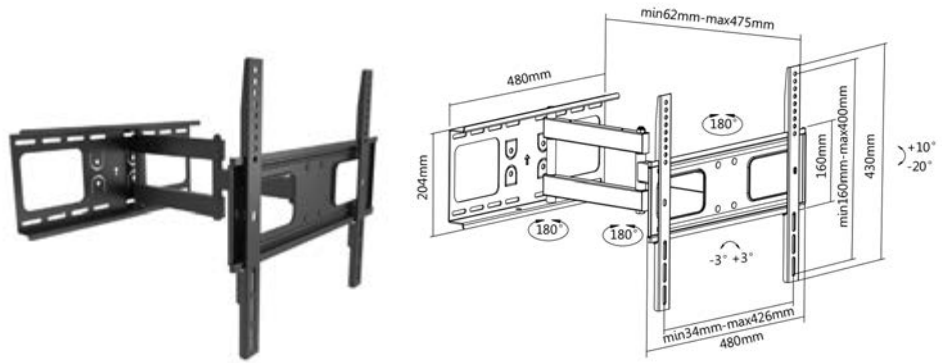

INSTALLATION VIDEO  
SCAN HERE:



### 37"-70" ARTICULATING TV WALL MOUNT BRACKET

Product N° - 650316

**KEY FEATURES**

- Max. Load Capacity: 50Kg
- Max. VESA: 600x400
- Built-in level adjustment ensures perfect positioning
- VESA standards compliant
- Full motion mount
- Free-tilting design for multiple monitor viewing angles

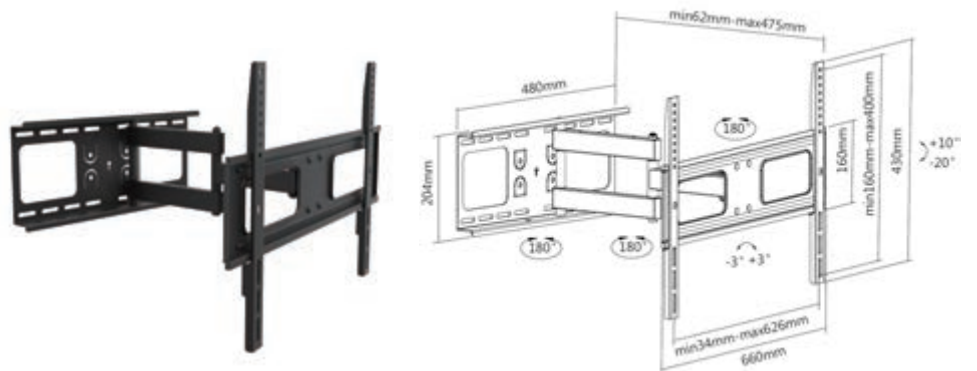

INSTALLATION VIDEO  
SCAN HERE:



### 32"-55" ARTICULATING TV WALL BRACKET

Product N° - 650341

**KEY FEATURES**

- Max. Load Capacity: 35Kg
- Max. VESA: 400x400
- Full motion mount
- VESA standards compliant
- Free-tilting design for multiple monitor viewing angles
- Level adjustment ensures perfect positioning
- Build-in cable management

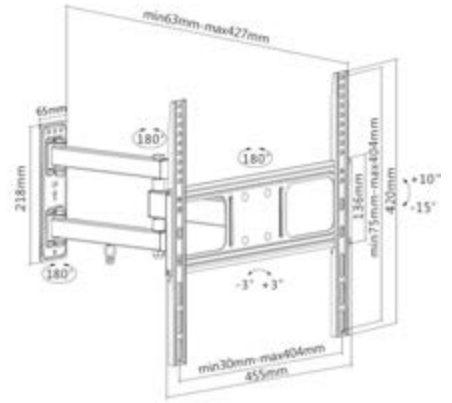

INSTALLATION VIDEO  
SCAN HERE:



### 37"-70" ARTICULATING TV WALL BRACKET

Product N° - 650342

**KEY FEATURES**

- Max. Load Capacity: 35Kg
- Max. VESA: 600x400
- Full motion mount
- VESA standards compliant
- Free-tilting design for multiple monitor viewing angles
- Level adjustment ensures perfect positioning
- Build-in cable management

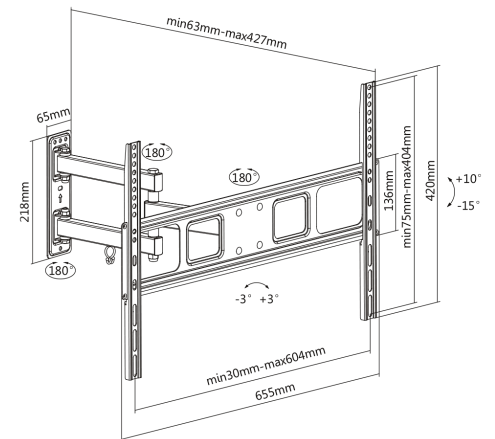

INSTALLATION VIDEO  
SCAN HERE:



## 37"-70" ARTICULATING TV WALL BRACKET

Product N° - 650342

### KEY FEATURES

- Max. Load Capacity: 35Kg
- Max. VESA: 600x400
- Full motion mount
- VESA standards compliant
- Free-tilting design for multiple monitor viewing angles
- Level adjustment ensures perfect positioning
- Build-in cable management

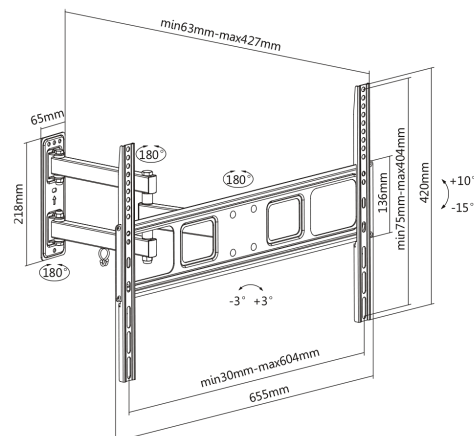

INSTALLATION VIDEO  
SCAN HERE:



## 43"-100" FULL MOTION TV MOUNT BRACKET

Product N° - 650348

NEW

### KEY FEATURES

- Max. Load Capacity: 60Kg
- Max. VESA: 800x400
- Detachable Panel
- Fixed Wall Plate
- Open Architecture: provides increased ventilation and easier access to wires
- Free-tilting & Swiveling Design: for multiple TV viewing angles
- Swiveling arm offer maximum viewing flexibility
- Built-in Cable management



Dimensions (mm)

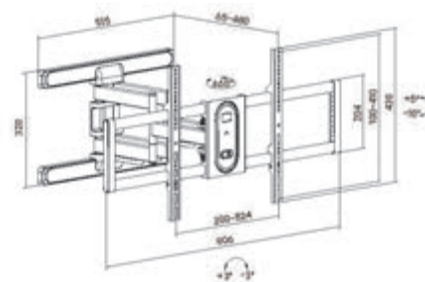

INSTALLATION VIDEO  
SCAN HERE:





## 37"-80" FULL MOTION TV MOUNT BRACKET

Product N° - 650337

### KEY FEATURES

- Max. Load Capacity: 40Kg
- Max. VESA: 600x400
- Swiveling arm offer maximum viewing flexibility
- Free-Tilting Design and reduced glare
- 2-Level adjustment ensures perfect positioning
- Swivel and tilt wall mount
- VESA standards compliant
- Cable clips keep cables organized and protected

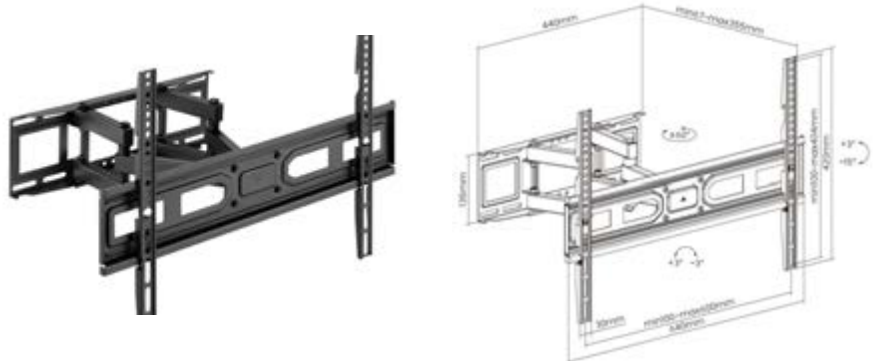

INSTALLATION VIDEO  
SCAN HERE:



## 60"-120" HEAVY-DUTY FULL MOTION TV MOUNT BRACKET

Product N° - 650343

### KEY FEATURES

- Max. Load Capacity: 120Kg
- Max. VESA: 900x600
- VESA standards compliant
- Extending Arm: provides a wide range of viewing angles
- Swiveling Arm(s): offer(s) maximum viewing flexibility
- Quick-Release Latch: locks/unlocks the display in place
- Built-in level adjustment ensures perfect positioning
- Free-Tilting Design and reduced glare

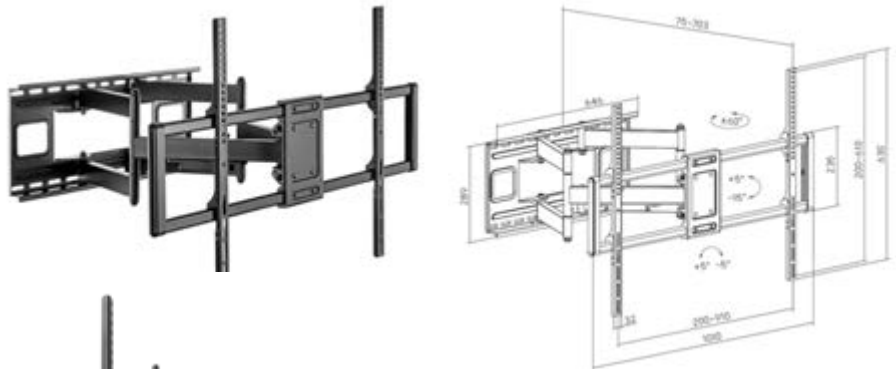

INSTALLATION VIDEO  
SCAN HERE:



## 43"-80" LONG ARM FULL MOTION TV WALL MOUNT BRACKET

Product N° - 650327

### KEY FEATURES

- Max. Loading capacity: 50kg
- Max. VESA : 800 x 400
- VESA standard compliant
- Swivel and Tilt wall mount
- Extending Arm: provides a wide range of viewing angles
- Quick-Release Latch: locks/unlocks the display in place
- Build-in Cable management

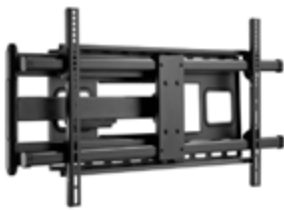
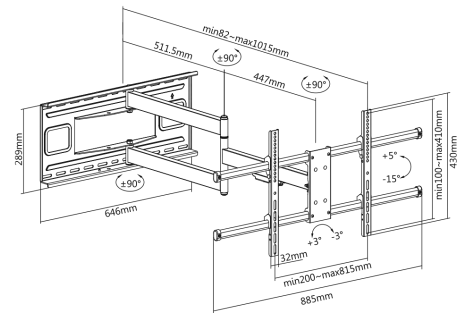

INSTALLATION VIDEO  
SCAN HERE:



## 43"-70" PULL-DOWN TV WALL MOUNT

Product N° - 650326

### KEY FEATURES

- Max. Load Capacity: 35Kg
- Max. VESA: 600x400
- VESA standards compliant
- Swivel and tilt wall mount
- Built-in level adjustment ensures perfect positioning
- Gas Piston Auto-Stabilization
- Cable Management: keeps everything organized

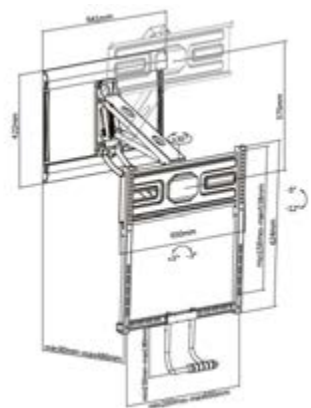

INSTALLATION VIDEO  
SCAN HERE:



## 37"-80" UNIVERSAL ROTATING WALL BRACKET

Product N° - 650331

### KEY FEATURES

- Max. Load Capacity: 50Kg
- Max. VESA: 600x400
- VESA standards compliant
- Portrait or Landscape viewing : one solution fits any installation
- Slide-in wall plate provides easy access for attachment and detachment
- Quick-Release latch: locks/unlocks the display in place
- Magnetic strap end : hides itself when not in used

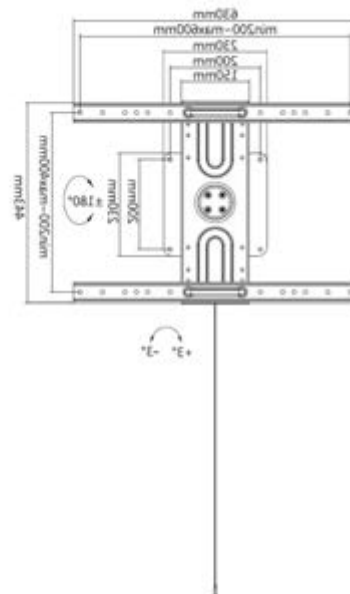

INSTALLATION VIDEO  
SCAN HERE:



## 23"-55" FULL MOTION CORNER TV WALL MOUNT BRACKET

Product N° - 650328

### KEY FEATURES

- Max. Load Capacity: 45Kg
- Max. VESA: 400x400
- VESA standards compliant
- Split Wall Plate: works on different angled corner walls and save space (also can be installed on flat wall)
- Free-tilting design for multiple monitor viewing angles
- Built-in level adjustment ensures perfect positioning
- Build-in cable management

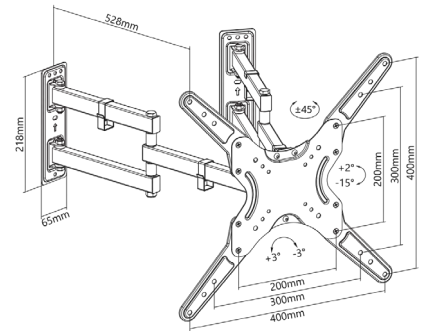

INSTALLATION VIDEO  
SCAN HERE:



## 37"-80" FULL MOTION TV WALL MOUNT BRACKET

Product N° - 650335

### KEY FEATURES

- Max. Load Capacity: 60Kg
- Max. VESA: 600x400
- Swiveling arm offer maximum viewing flexibility
- Built-in level adjustment ensures perfect positioning
- Swivel and tilt wall mount
- VESA standards compliant
- Build-in cable management

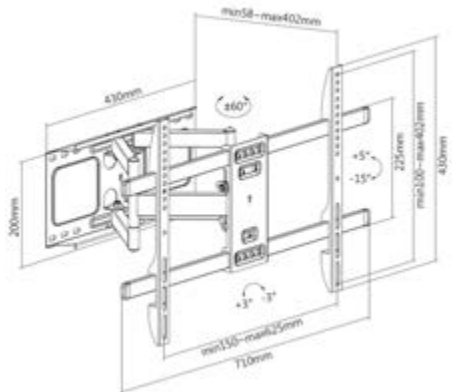

INSTALLATION VIDEO  
SCAN HERE:





## 55"-86" INTERACTIVE UP-DOWN TV WALL MOUNT

Product N° - 650345



### KEY FEATURES

- Max VESA: 600 x 600
- Max Loading weight: 65kg
- Built-in Cable management
- VESA standards compliant
- Manual Height-Adjustable Display Wall Mount
- Smooth and Effortless Height Adjustment: high-low adjustment with finger touch positioning
- Weight Balance Design: easily accommodates the different weights of displays
- Heavy-Duty steel construction holds the heaviest TVs with confidence.
- Compact Design: allows the mount to hide behind the screen when not in use
- High Quality Powder-Coated Finish: features a stylish anti-scratch surface

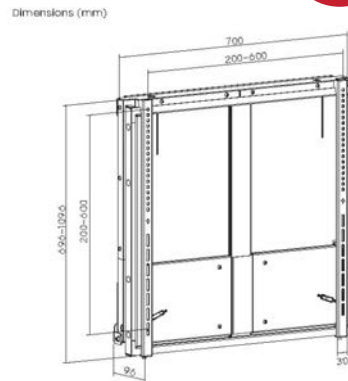

INSTALLATION VIDEO  
SCAN HERE:



## 60"-100" INTERACTIVE UP-DOWN TV WALL MOUNT

Product N° - 650346



### KEY FEATURES

- Max VESA: 800 x 600
- Max Loading weight: 90kg
- Built-in Cable management
- VESA standards compliant
- Manual Height-Adjustable Display Wall Mount
- Smooth and Effortless Height Adjustment: high-low adjustment with finger touch positioning
- Weight Balance Design: easily accommodates the different weights of displays
- Heavy-Duty steel construction holds the heaviest TVs with confidence.
- Compact Design: allows the mount to hide behind the screen when not in use
- High Quality Powder-Coated Finish: features a stylish anti-scratch surface

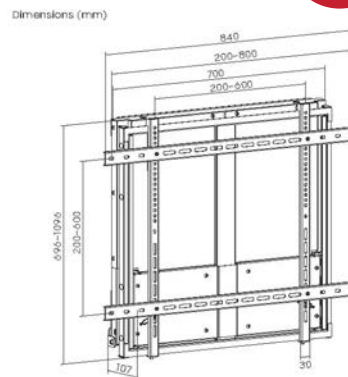

INSTALLATION VIDEO  
SCAN HERE:





# MULTIMEDIA MOUNT SOLUTIONS

## UNIVERSAL SOUNDBAR MOUNT

Product N° - 650895

### KEY FEATURES

- Max. Load Capacity: 15Kg
- Applicable Device size: Soundbar (Width: 86~155mm)
- High Compatibility: support most any popular devices
- EVA padded base prevents vibration noise
- Anti-fall hooks firmly secure the soundbar
- One-fit-all design makes mounting the soundbar above or below the TV

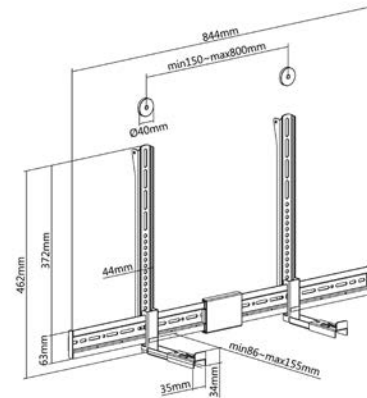

INSTALLATION VIDEO  
SCAN HERE:



## UNIVERSAL MEDIA PLAYER MOUNT

Product N° - 650896

### KEY FEATURES

- Max. Load Capacity: 1Kg
- Applicable Device size: (32-46MM width)
- Open Construction design
- Rotary Knob Design: for easy assembly or adjustment

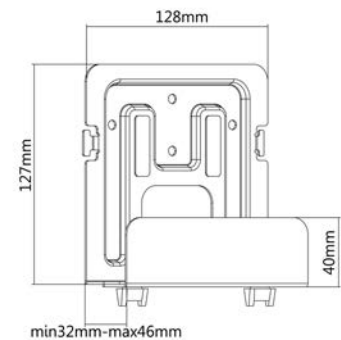

INSTALLATION VIDEO  
SCAN HERE:



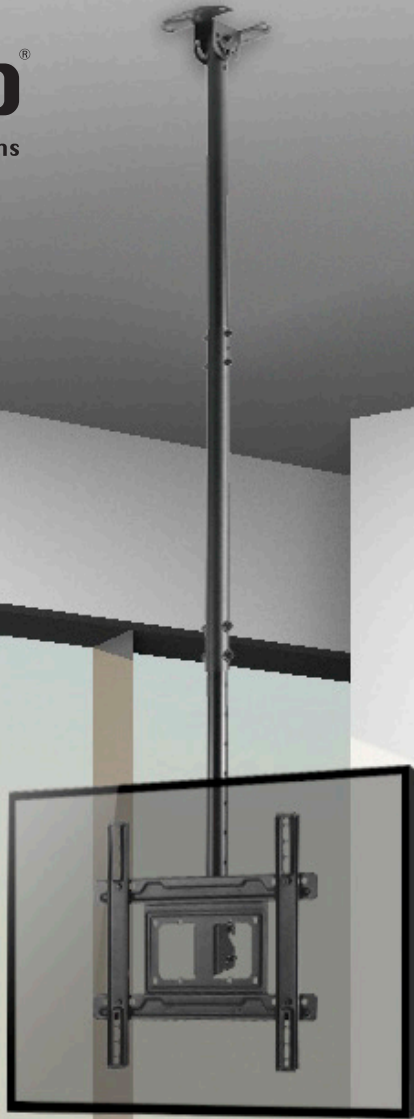

## MOTORIZED MOUNT SOLUTIONS



## 32"-70" MOTORIZED TV CEILING MOUNT BRACKET

Product N° - 650329

### KEY FEATURES

- Max. Load Capacity: 35Kg
- Max. VESA: 600x400
- VESA standards compliant
- Flip down design: allows for easy storage, save space
- Level adjustment ensures perfect positioning
- Built-in Cable management
- Remote Control Included: for easy movements

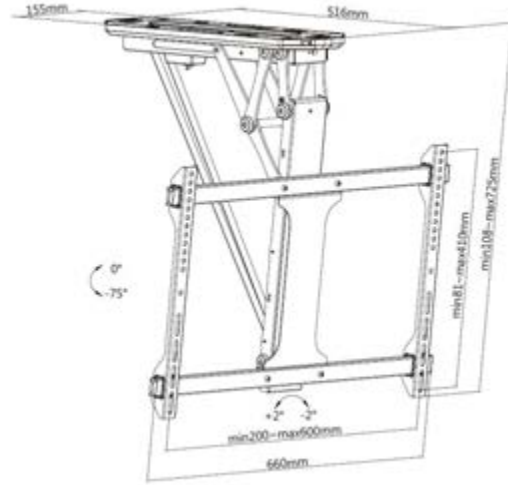

INSTALLATION VIDEO  
SCAN HERE:



## 32"-75" MOTORIZED TV SWING MOUNT BRACKET

Product N° - 650336

### KEY FEATURES

- Max. Load Capacity: 50Kg
- Max. VESA: 600x400
- VESA standards compliant
- Level adjustment ensures perfect positioning
- Built-in Cable management
- Powerful Motor: more stable, strong and durable
- Remote Control Included: for easy movements
- Collision Avoidance System: safeguards against accidents and injuries
- Low profile: 56mm extra slim design
- Programmable Position Memory Function records the position you like

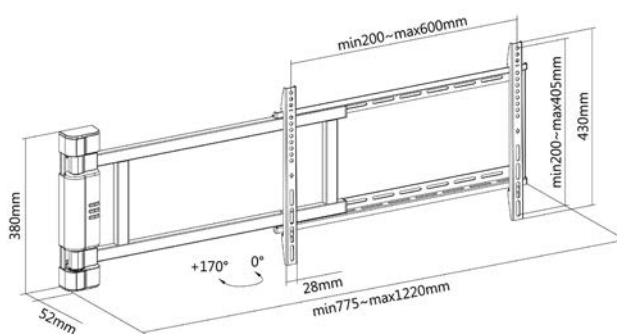

INSTALLATION VIDEO  
SCAN HERE:



## 37"-65" MOTORIZED REMOTE CONTROL TV STAND

Product N° - 650606

### KEY FEATURES

- Max. Load Capacity: 50Kg
- Max. VESA: 600x400
- VESA standards compliant
- Lift Design: create unique enclosures or cabinets to conceal TVs
- Height adjustment Integrated cable management
- Remote Control Included: for easy movements
- Strong lifting power with low noise level
- Powerful Motor: more stable, strong and durable

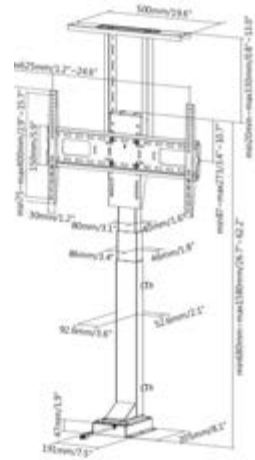

INSTALLATION VIDEO  
SCAN HERE:



## 32"-65" MOTORIZED TV TABLETOP STAND

Product N° - 650610

### KEY FEATURES

- Max. Load Capacity: 50Kg
- Max. VESA: 400x400
- Powerful Motor: more stable, strong and durable
- Collision Avoidance System: safeguards against accidents and injuries
- Height Level adjustment ensures perfect positioning
- Cable clips keep cables organized and protected
- Remote Control Included: for easy movements
- VESA standards compliant
- Large Solid Base: ensures it stay sturdy and stable at any height



INSTALLATION VIDEO  
SCAN HERE:



## 55"-100" FIXED MOTORIZED WALL MOUNT STAND

Product N° - 650347



### KEY FEATURES

- Max. Load Capacity: 120Kg
- Max. VESA: 800x600
- VESA standards compliant
- Multiple Motors: offer heavier lifting ability and increased stability
- Remote Control Included: for easy movements
- Heavy-Duty steel construction holds the heaviest TVs with confidence.
- Heavy-Duty Casters with Locking Mechanism: can be moved or stopped at will
- Height adjustable TV mount

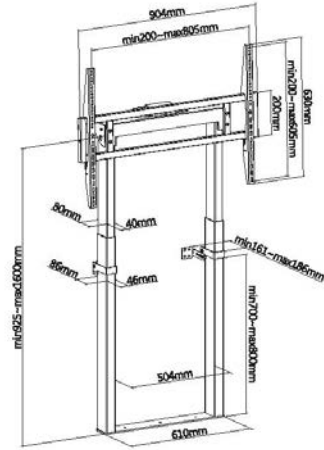

INSTALLATION VIDEO  
SCAN HERE:





## 55"-100" MOBILE MOTORIZED TV CART

Product N° - 650632



### KEY FEATURES

- Max. Load Capacity: 120Kg
- Max VESA support 800x600
- Standard Motorized TV Cart
- Multiple Motors: offer heavier lifting ability and increased stability
- Height adjustment
- Heavy-Duty steel construction holds the heaviest TVs with confidence.
- Wheels for mobility, lockable for safety
- Remote Control Included: for easy movements

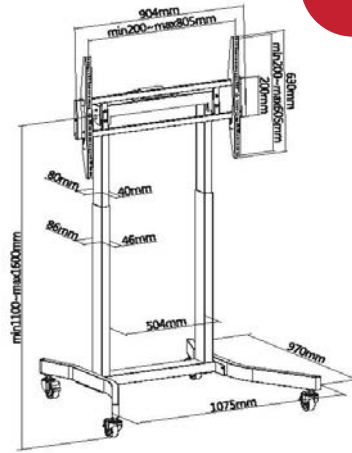

INSTALLATION VIDEO  
SCAN HERE:



## 55"-100" MOBILE MOTORIZED TV CART

Product N° - 650633



### KEY FEATURES

- Max. Load Capacity: 120Kg
- Max VESA support 800x600
- Multiple Motors: offer heavier lifting ability and increased stability
- Height adjustment
- Free-Tilting Design: makes easy forward or backward adjustment for better viewing and reduced glare
- Heavy-Duty steel construction holds the heaviest TVs with confidence.
- Wheels for mobility, lockable for safety
- Remote Control Included: for easy movem

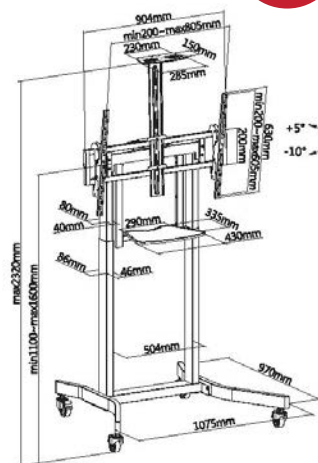

INSTALLATION VIDEO  
SCAN HERE:





# TV STAND SOLUTIONS

## 32"-55" UNIVERSAL TV TABLETOP STAND

Product N° - 650601

### KEY FEATURES

- Max. loading capacity: 40kg
- VESA support Max. 600 x 400
- VESA standards compliant
- Height of the TV is adjustable
- Elegant glossy glass base
- Build-in cable management

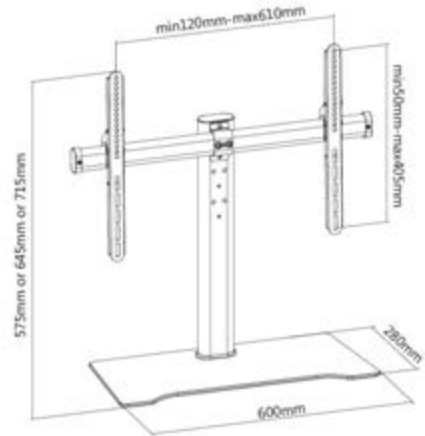

INSTALLATION VIDEO  
SCAN HERE:



## 37"-75" TV FLOOR STAND

Product N° - 650613

### KEY FEATURES

- Max. loading capacity: 40kg
- VESA support Max. 600 x 400
- Free-tilting design for multiple monitor viewing angles
- Height of the TV is adjustable
- Equipment Shelf: provides more storage space for accessories
- VESA standards compliant
- Cable clips keep cables organized and protected

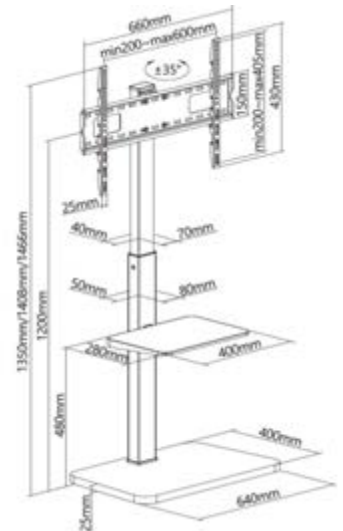

INSTALLATION VIDEO  
SCAN HERE:



## 32"-55" UNIVERSAL TV STANDS

Product N° - 650611

### KEY FEATURES

- Max. loading capacity: 40kg
- VESA support Max. 400 x 400
- VESA standards compliant
- Height adjustment
- Continuous swivel: for an optimal viewing angel
- Elegant glossy glass base
- Build-in cable management

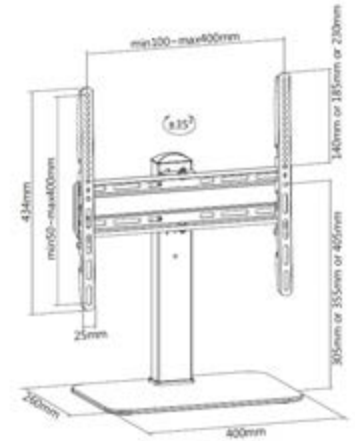

INSTALLATION VIDEO  
SCAN HERE:



## 37"-70" UNIVERSAL TV STANDS

Product N° - 650612

### KEY FEATURES

- Max. loading capacity: 40kg
- VESA support Max. 600 x 400
- VESA standards compliant
- Height adjustment
- Continuous swivel: for an optimal viewing angel
- Elegant glossy glass base
- Build-in cable management

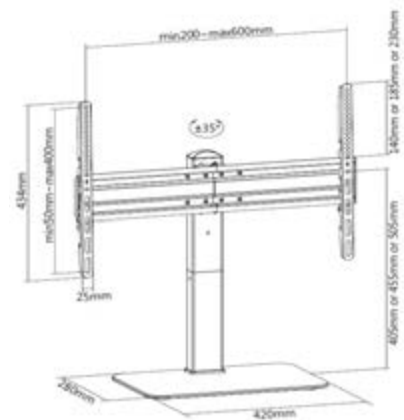

INSTALLATION VIDEO  
SCAN HERE:





## 32"-65" MOTORIZED TV TABLETOP STAND

Product N° - 650610

### KEY FEATURES

- Max. Load Capacity: 50Kg
- Max. VESA: 400x400
- VESA standards compliant
- Powerful Motor: more stable, strong and durable
- Collision Avoidance System: safeguards against accidents and injuries
- Height Level adjustment ensures perfect positioning
- Built-in Cable management
- Remote Control Included: for easy movements

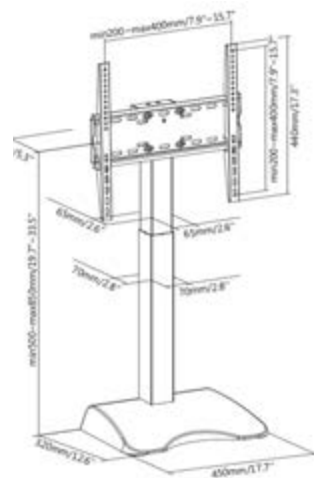

INSTALLATION VIDEO  
SCAN HERE:





## TV CART SOLUTIONS

### 32"-55" UNIVERSAL TV CART

Product N° - 650607

**KEY FEATURES**

- Max. Load Capacity: 35Kg
- Max. VESA: 400x400
- VESA standards compliant
- Wheels for mobility, lockable for safety
- Telescopic height adjustment for optimum visibility
- Free-tilting design for multiple monitor view- ing angles
- Integrated cable management system
- DVD/AV component shelf

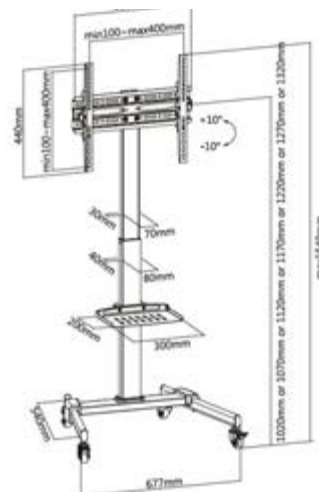

INSTALLATION VIDEO  
SCAN HERE:



### 37"-70" ECONOMY MULTI-FUNCTIONAL TV CART

Product N° - 650603

**KEY FEATURES**

- Max. Load Capacity: 50Kg
- Max. VESA: 600x400
- Height adjustment
- DVD/AV component shelf
- Wheels for mobility, lockable for safety
- Free-tilting design for multiple monitor viewing angles
- Adjustable camera shelf/DVD shelf height for the desired position
- VESA standards compliant
- Integrated cable management system

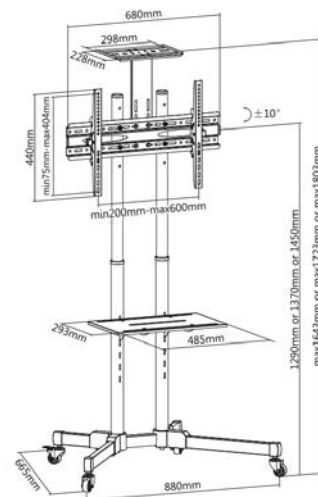

INSTALLATION VIDEO  
SCAN HERE:



## 37-70" 90° ROTATE SINGLE DISPLAY TV CART

Product N° - 650602

### KEY FEATURES

- Max. Load Capacity: 50Kg
- Max. VESA: 600x400
- Height adjustment
- Adjustable camera shelf/DVD shelf height for the desired position
- Free-tilting design for multiple monitor viewing angles
- Wheels for mobility, lockable for safety
- 90° rotation for easily holding display in portrait or landscape orientation
- DVD/AV component shelf
- Screen Rotation: 90°
- VESA standards compliant
- Built-in Cable management

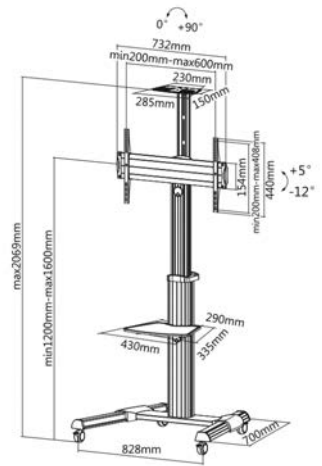

INSTALLATION VIDEO  
SCAN HERE:



## 37-86" ROTATE TV CART

Product N° - 650630

### KEY FEATURES

- Max. Load Capacity: 50Kg
- Max. VESA: 600x400
- Adjustable camera shelf/DVD shelf height for the desired position
- Height adjustment
- Free-tilting design for multiple monitor viewing angles
- Wheels for mobility, lockable for safety
- 90° rotation for easily holding display in portrait or landscape orientation
- DVD/AV component shelf
- Cable clips keep cables organized and protected

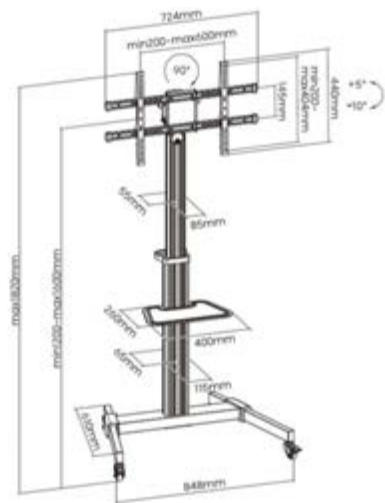

INSTALLATION VIDEO  
SCAN HERE:





## 60"-100" ULTRA-LARGE TELESCOPIC DISPLAY TV CART

Product N° - 650605

### KEY FEATURES

- Max. Load Capacity: 100Kg
- Max. VESA: 1000x600
- Height adjustment
- Free-tilting design for multiple monitor viewing angles
- Built-in Cable management
- Quick-release spring lock adjusts height effortlessly
- Quick assembly shelf assures easy post-intallation and height adjustable
- Wheels for mobility, lockable for safety
- DVD/AV component shelf
- Adjustable camera shelf/DVD shelf height for the desired position

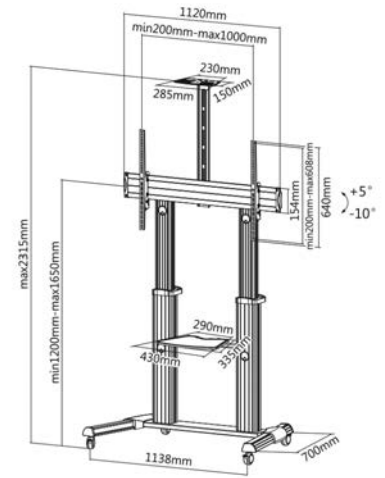

INSTALLATION VIDEO  
SCAN HERE:



## 60"-100" ECO ULTRA-LARGE DISPLAY TV CART

Product N° - 650631

NEW

### KEY FEATURES

- Max. Load Capacity: 100Kg
- Max VESA support 1000 x 600
- Height adjustment
- Free-tilting design for multiple monitor viewing angles
- Built-in Cable management
- Quick-release spring lock adjusts height effortlessly
- Quick assembly shelf assures easy post-intallation and height adjustable
- DVD/AV component shelf
- Wheels for mobility, lockable for safety
- Adjustable camera shelf/DVD shelf height for the desired position

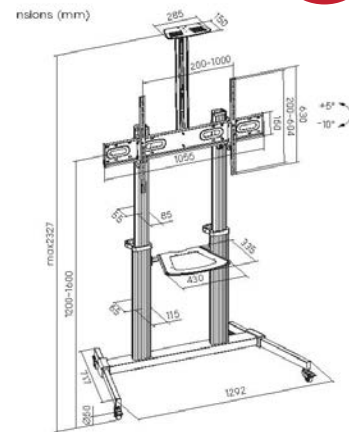

INSTALLATION VIDEO  
SCAN HERE:



### 37"-80" HEAVY-DUTY TV CART

Product N° - 650608

**KEY FEATURES**

- Max. Load Capacity: 80Kg
- Max VESA support 600x400
- Height adjustment
- Built-in Cable management
- DVD/AV component shelf
- Wheels for mobility, lockable for safety
- VESA standards compliant
- Anti-Theft Locking Hole: for additional security preventing

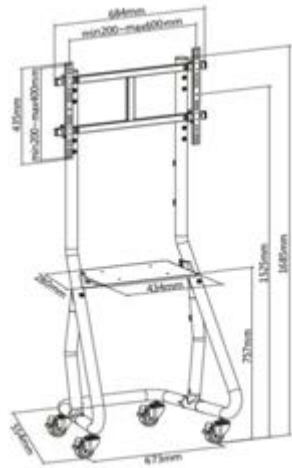

INSTALLATION VIDEO  
SCAN HERE:



### 60"-105" HEAVY-DUTY TV CART

Product N° - 650609

**KEY FEATURES**

- Max. Load Capacity: 100Kg
- Max VESA support 1000x600
- Height adjustment
- Built-in Cable management
- DVD/AV component shelf
- Wheels for mobility, lockable for safety
- VESA standards compliant
- Anti-Theft Locking Hole: for additional security preventing

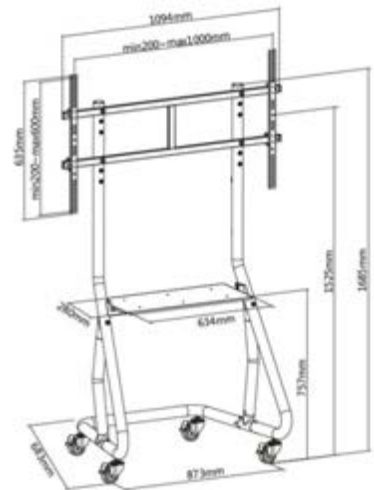

INSTALLATION VIDEO  
SCAN HERE:



## 55"-100" MOBILE MOTORIZED TV CART

Product N° - 650632



### KEY FEATURES

- Max. Load Capacity: 120Kg
- Max VESA support 800x600
- Standard Motorized TV Cart
- Multiple Motors: offer heavier lifting ability and increased stability
- Height adjustment
- Heavy-Duty steel construction holds the heaviest TVs with confidence.
- Wheels for mobility, lockable for safety
- Remote Control Included: for easy movements

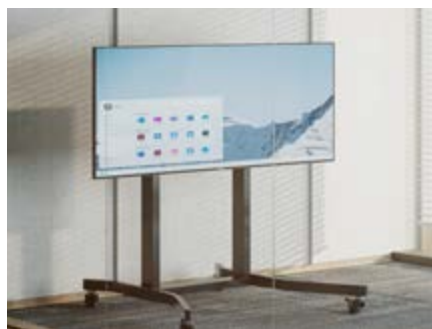
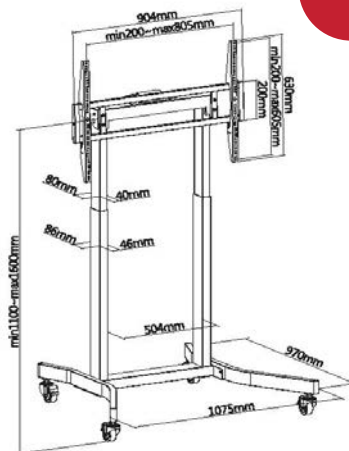

INSTALLATION VIDEO  
SCAN HERE:



## 55"-100" MOBILE MOTORIZED TV CART

Product N° - 650633



### KEY FEATURES

- Max. Load Capacity: 120Kg
- Max VESA support 800x600
- Multiple Motors: offer heavier lifting ability and increased stability
- Height adjustment
- Free-Tilting Design: makes easy forward or backward adjustment for better viewing and reduced glare
- Heavy-Duty steel construction holds the heaviest TVs with confidence.
- Wheels for mobility, lockable for safety
- Remote Control Included: for easy movem

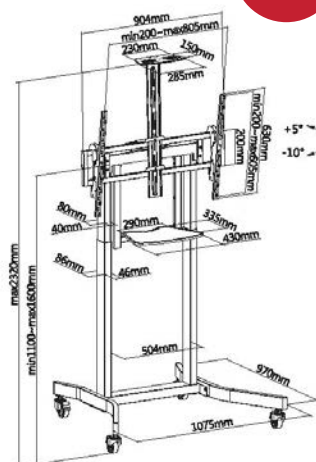

INSTALLATION VIDEO  
SCAN HERE:







# PROFESSIONAL TV CEILING SOLUTIONS

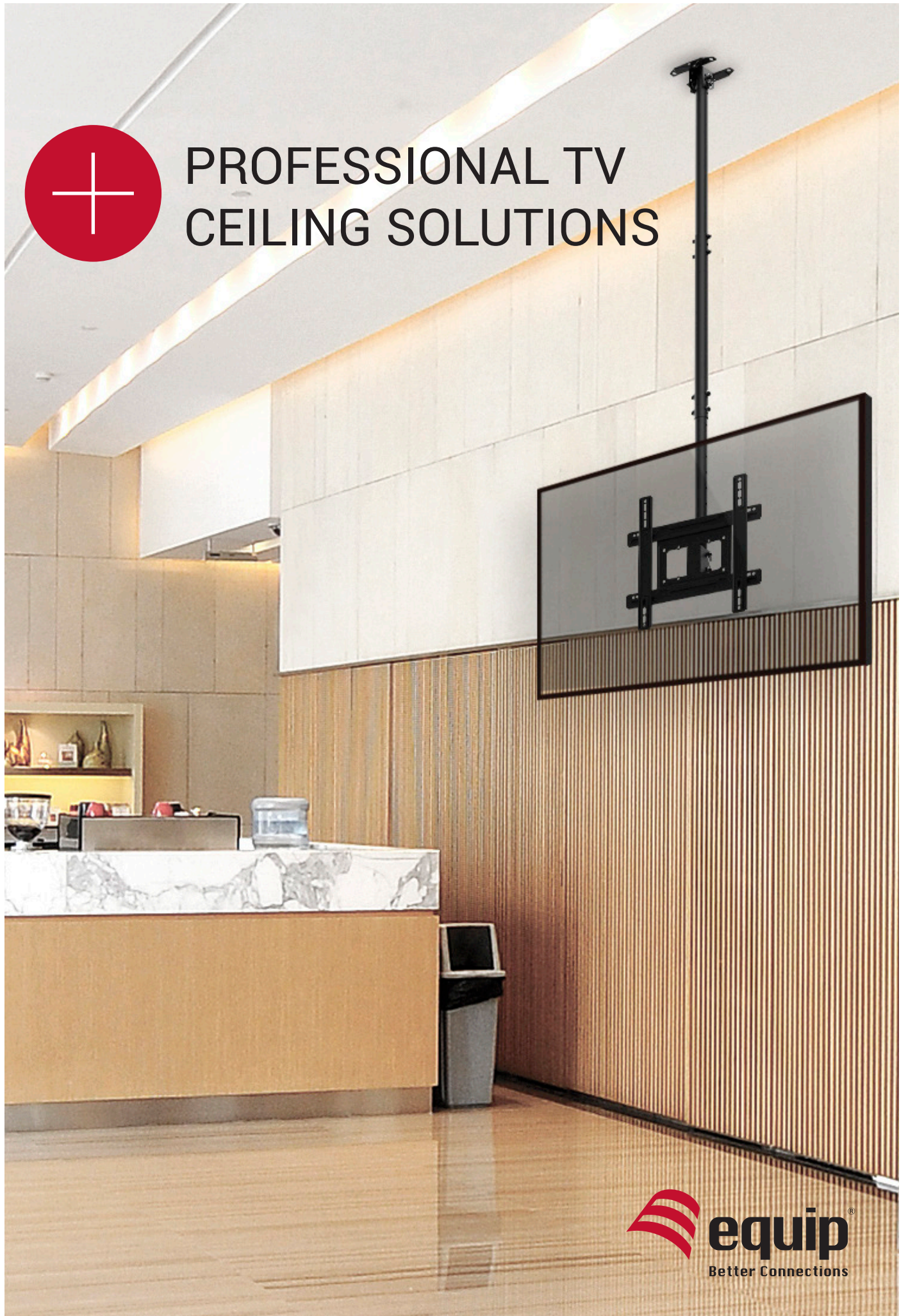



## 23"-55" CEILING MOUNT TV BRACKET

Product N° - 650375

### KEY FEATURES

- Max. Load Capacity: 20Kg
- Max. VESA: 400x400
- Economical Folding Ceiling Mount
- Folding Design: saves space
- Swivel Ability: for multiple screen viewing angles
- Flexible Sliding Rails: for adjusting screen height

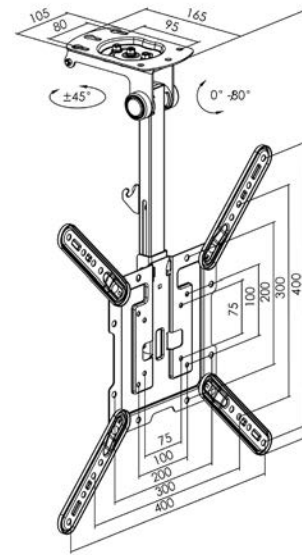

INSTALLATION VIDEO  
SCAN HERE:



## 32"-70" CEILING MOUNT TV BRACKET

Product N° - 650321

### KEY FEATURES

- Telescopic height adjustment for optimum visibility
- Freely angling and swiveling for different viewing angles
- Removable VESA attachment for easy installation
- Integrated cable management
- Max. Load Capacity: 50Kg
- Max. VESA: 400x400
- VESA standards compliant

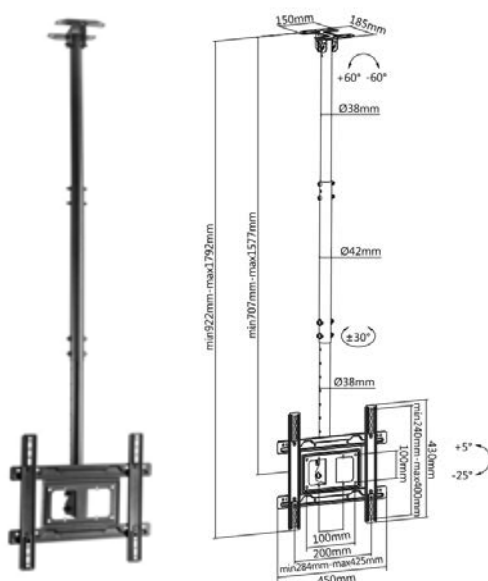

INSTALLATION VIDEO  
SCAN HERE:



## 39"-75" CEILING MOUNT DUAL SCREEN TV BRACKET

Product N° - 650370

### KEY FEATURES

- Compatible with landscape and portrait mounting
- Integrated bubble level assures easy installation alignment
- Adjustment knob enables a full range of tilt/swivel action
- VESA standards compliant
- Built-in Cable management
- Max VESA support: 600 x 400
- Max Loading weight : 40kgs (per screen)

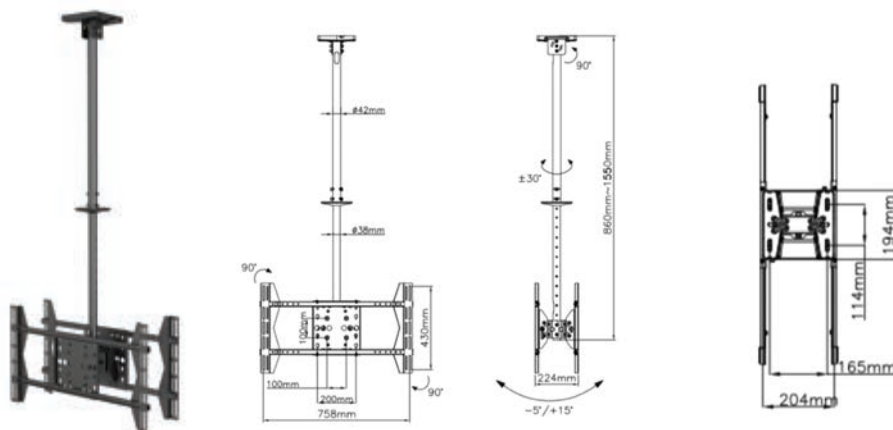

### 32"-65" CEILING MOUNT TRIPLE SCREEN TV BRACKET

Product N° - 650371

**KEY FEATURES**

- Compatible with landscape and portrait mounting
- Integrated bubble level assures easy installation alignment
- Adjustment knob enables a full range of tilt/swivel action
- Max. VESA: 600x400
- VESA standards compliant
- Built-in Cable management
- Max. Load Capacity: 30Kg per screen

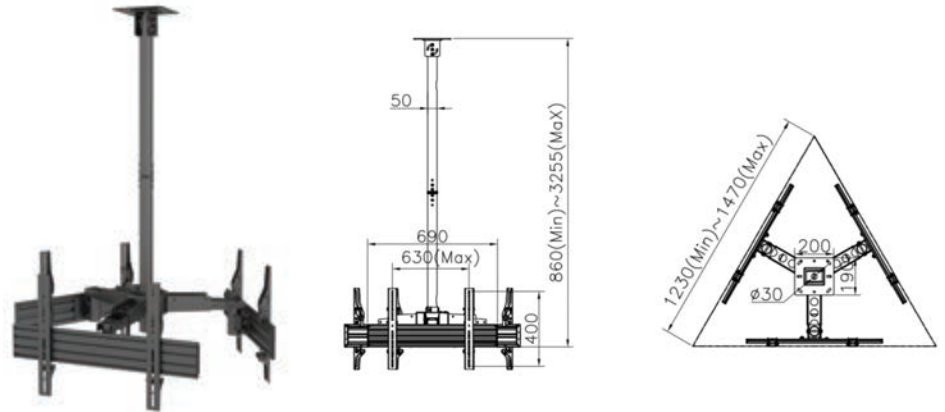

INSTALLATION VIDEO  
SCAN HERE:



### 32"-65" CEILING MOUNT QUAD SCREEN TV BRACKET

Product N° - 650372

**KEY FEATURES**

- Integrated bubble level assures easy installation alignment
- Adjustment knob enables a full range of tilt/swivel action
- Compatible with landscape and portrait mounting
- Built-in Cable management
- Max. VESA: 600x400
- VESA standards compliant
- Max. Load Capacity: 30Kg per screen

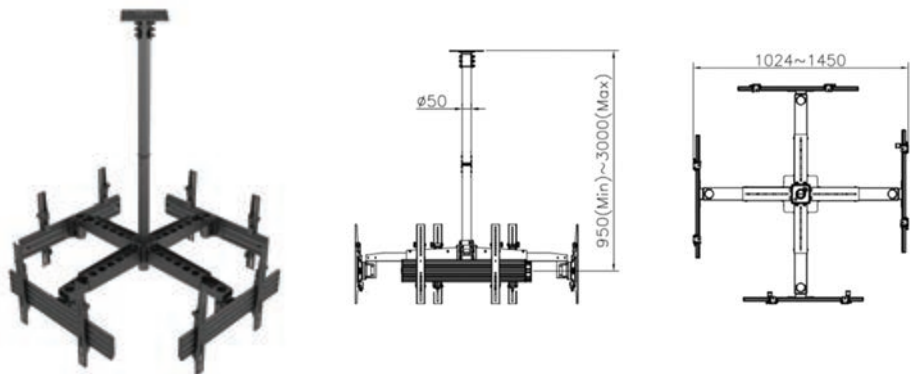

INSTALLATION VIDEO  
SCAN HERE:



## 45"-55" DUAL SCREEN CEILING MOUNT

Product N° - 650373

### KEY FEATURES

- support TV 45"-55"
- Max. Load Capacity: 50Kg (per screen)
- Max. VESA: 600x400
- Free-tilting & Swiveling Design
- Sturdy and lightweight aluminum construction
- Level adjustment ensures perfect positioning
- Integrated cable management system
- Anti-Theft Locking Hole: for additional security preventing any unwanted removal

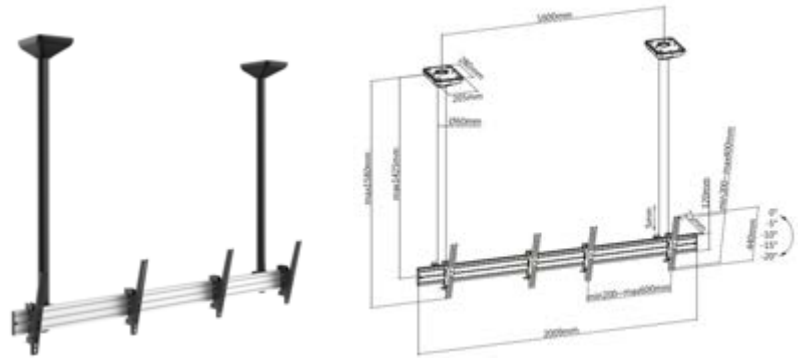

INSTALLATION VIDEO  
SCAN HERE:



## 45"-50" TRIPLE SCREEN CEILING MOUNT

Product N° - 650374

### KEY FEATURES

- support TV 45"-50"
- Max. Load Capacity: 50Kg (per screen)
- Max. VESA: 600x400
- Free-tilting & Swiveling Design
- Sturdy and lightweight aluminum construction
- Level adjustment ensures perfect positioning
- Integrated cable management system
- Anti-Theft Locking Hole: for additional security preventing any unwanted removal

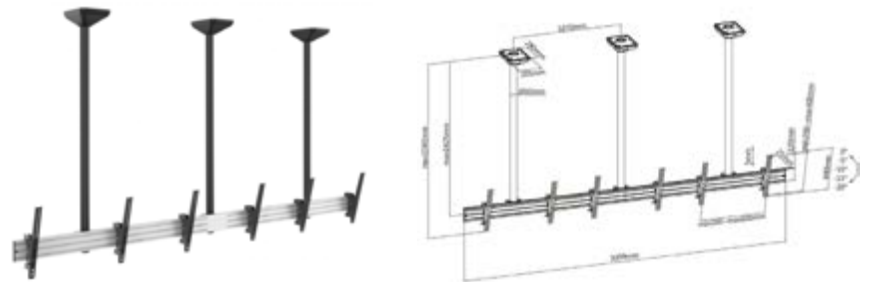

INSTALLATION VIDEO  
SCAN HERE:





## 37"-70" FLOOR-TO-CEILING TV BRACKET

Product N° - 650621

### KEY FEATURES

- VESA support Max. 600 x 400
- Max. loading capacity: 30kg
- Free-tilting design for multiple monitor viewing angles
- 360° Flexible Swiveling Ability makes it easy to rotate smoothly.
- Vertical Height Adjustment: for proper positioning
- Equipment Shelf: provides more storage space for accessories
- VESA standards compliant
- Cable clips keep cables organized and protected

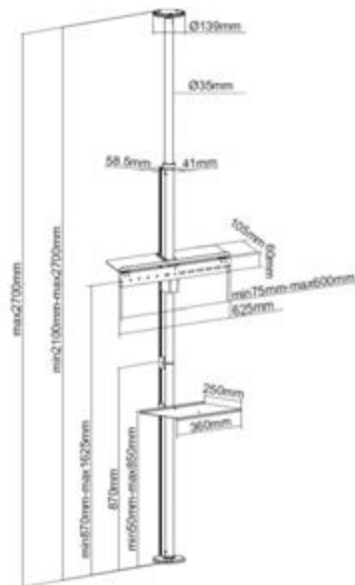

INSTALLATION VIDEO  
SCAN HERE:





## PROJECTOR MOUNT SOLUTIONS

## PROJECTOR CEILING MOUNT BRACKET

Product N° - 650705



### KEY FEATURES

- Universal Ceiling Projector Mount
- 360° Rotating Joint: for optimal viewing angles
- Swiveling Joint: offers maximum viewing flexibility
- Adjustable Support Arms: fit most projectors with ease
- Integrated cable management system
- Max. Load Capacity: 13.5Kg



Dimensions (mm)

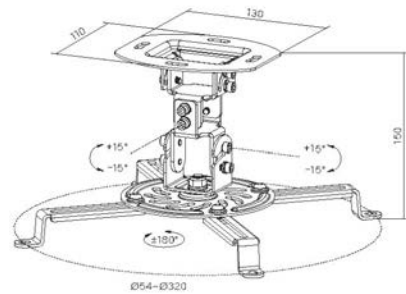

INSTALLATION VIDEO  
SCAN HERE:



## PROJECTOR CEILING WALL MOUNT BRACKET

Product N° - BLACK 650702 | WHITE 650703

### KEY FEATURES

- Sturdy and lightweight steel construction
- Height adjustment : 430-650mm
- Suitable for projectors with a pitch circle diameter of 225-315mm
- Integrated cable management system
- Max. Load Capacity: 20Kg / 44 Lbs

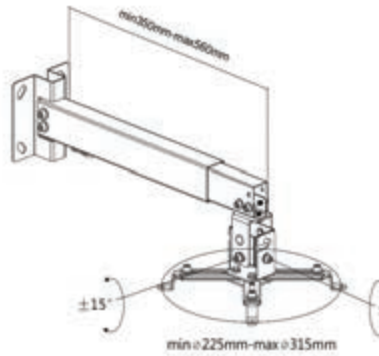
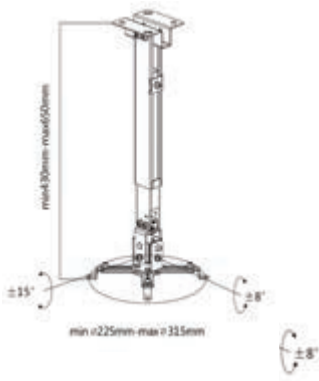

INSTALLATION VIDEO  
SCAN HERE:





## PROJECTOR CEILING MOUNT BRACKET

Product N° - 650700

### KEY FEATURES

- Sturdy and lightweight aluminum construction
- Integrated cable management system
- Height adjustment: 130/220mm
- Suitable for projectors with a pitch circle diameter of 225-315mm
- Max. Load Capacity: 10Kg/22Lbs
- Rotation: 360°

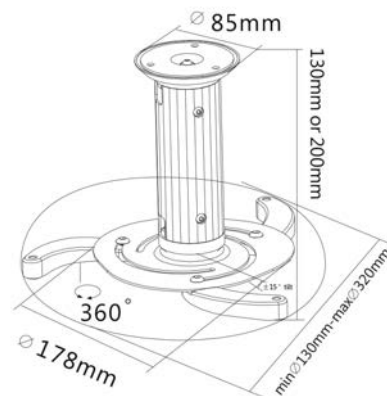

INSTALLATION VIDEO  
SCAN HERE:





# PROFESSIONAL DIGITAL SIGNAGE SOLUTIONS





### 37"-65" MODULAR PUSH-IN POP-OUT TV WALL MOUNT BRACKET

Product N° - 650355

**KEY FEATURES**

- Compatible with landscape and portrait mounting
- Push-In Pop-Out for easy access and after service
- Built-in Cable management
- Modular mount with unlimited video display configurations
- Max. VESA: 600x400
- VESA standards compliant
- Max. Load Capacity: 30Kg per screen

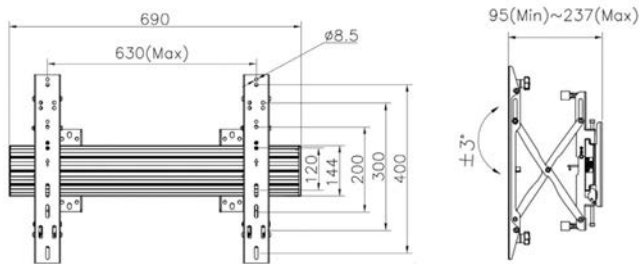

INSTALLATION VIDEO  
SCAN HERE:



### 43"-70" PUSH-IN POP-OUT TV WALL MOUNT BRACKET

Product N° - 650325

**KEY FEATURES**

- Compatible with landscape and portrait mounting
- Push-In Pop-Out for easy access and after service
- Modular mount with unlimited video display configurations
- Max. VESA: 600x400
- Built-in Cable management
- Max. Load Capacity: 50Kg per screen

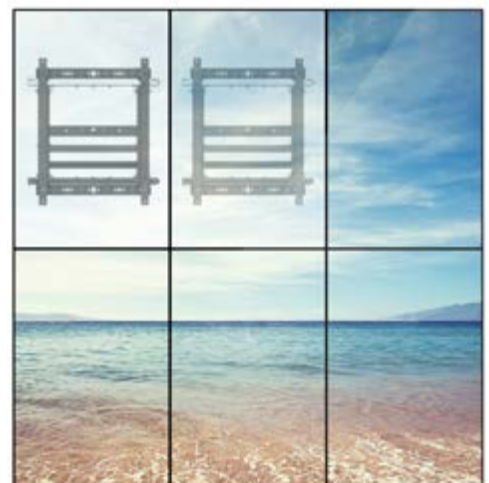
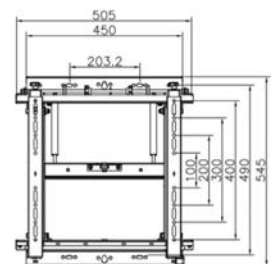
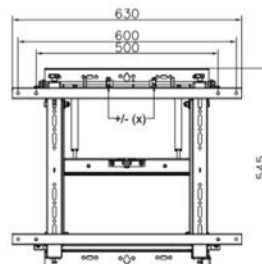

INSTALLATION VIDEO  
SCAN HERE:



## 37"-70" POP-OUT VIDEO WALL MOUNT BRACKET

Product N° - 650351

### KEY FEATURES

- Max VESA: 600 x 400
- Max Loading weight: 45kgs
- Built-in Cable management
- VESA standards compliant
- Anti-Theft Locking Hole: for additional security preventing
- Modular mount with unlimited video display configurations
- Pop-Out Lock System: ensures safety by reducing the possibility of accidental pop-outs
- Pop-Out extension provides quick access for installation and maintenance
- Compatible with landscape mounting

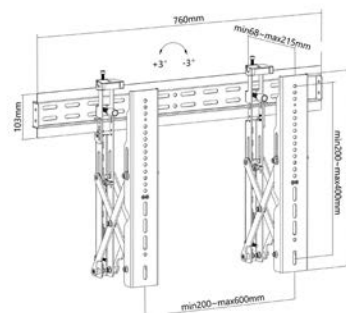

INSTALLATION VIDEO  
SCAN HERE:



## 45"-70" POP-OUT VIDEO WALL MOUNT BRACKET

Product N° - 650352

### KEY FEATURES

- Max VESA: 600 x 400
- Max Loading weight: 70kgs
- Built-in Cable management
- VESA standards compliant
- Anti-Theft Locking Hole: for additional security preventing
- Modular mount with unlimited video display configurations
- Effortless Micro-Adjustments: allow seamless display alignment
- Pop-Out Lock System: ensures safety by reducing the possibility of accidental pop-outs.
- Effortless Micro-Adjustments allow seamless display alignment
- Innovative Quick-Release for easy installation
- Compatible with landscape and portrait mounting

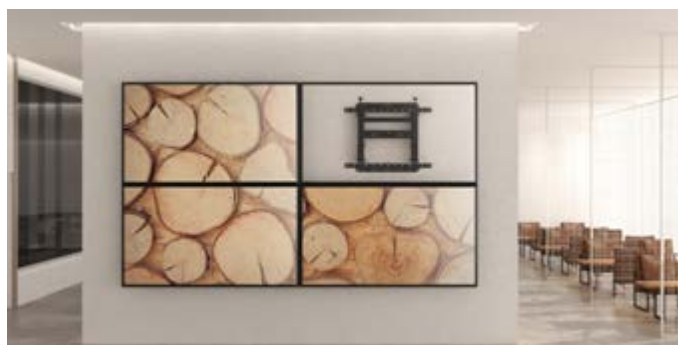
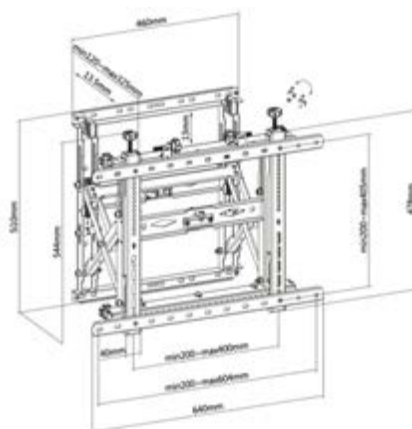

INSTALLATION VIDEO  
SCAN HERE:













[www.equip-info.net](http://www.equip-info.net)



Technical specifications are subject to change without notice.  
© Copyright Digital Data Communications GmbH. All Rights Reserved.  
Im Defdahl 10F, 44141 Dortmund, Germany

DISTRIBUTED BY

2024.07.EN