



Switch Gigabit WebSmart de 28 puertos, 4 x Gigabit SFP/RJ45 Combo

The GES-2451 Switch is a gigabit web smart switch, which can be configured by web interface. It provides a simple, economic, high performance gigabit network solution. All RJ45 ports support Auto MDI/MDIX, port speed limit, IGMP Snooping, storm control, Port based VLAN/MAC address binding, configuration file upload and download etc. Providing huge flexibility based on workgroup performance improvement, easy installation, superior performance, highly cost effective.

Key Features

- Transmisión y recepción a 10/100/1000 Mbps a velocidad de cable
- IEEE 802.1d/w Spanning Tree Protocol (STP) y duplicación de puertos
- Admite redes VLAN basadas en puertos, etiquetado VLAN IEEE 802.1Q
- Filtrado IP Multicast a través de indagación IGMP V1/ V2/ V3
- 10000 marcos jumbo para aumentar las velocidades de transferencia de datos
- Admite aprendizaje automático y envejecimiento automático de 8000 direcciones MAC
- La funcionalidad de inspección ARP dinámica (DAI, Dynamic ARP Inspection) protege los conmutadores contra la suplantación de ARP.

Specifications

System Specifications

Estándares:

IEEE 802.3x Ethernet frame start and stop requests and timers used for flow control on full-duplex links

IEEE 802.3u CSMA/CD access method and physical layer specifications for 100 BASE-TX Fast Ethernet

IEEE 802.3z CSMA/CD access method and physical layer specifications for 1000 BASE Gigabit Ethernet

IEEE 802.1q Virtual LAN

IEEE 802.1d Spanning Tree Protocol

IEEE 802.3ad Link Aggregation Control Protocol (LACP)

**Memoria:**

128MB

Buffer de Memoria:

4.1Mbit

Puerto:

24 x 10/100/1000 Base-T & 4 x 1G combo

Botón / Perilla:

reset

Indicador:

LED indicators : Port, System,link

Método de transmisión:

Store- forward

Entrada de alimentación:

AC Input : 100 to 240 V, 50-60 Hz, 2 A

Salida de potencia:

12V/2A

El consumo de energía:

12W

Plano posterior (Gbps):

52Gbps

Tabla de direcciones MAC:

8k

Velocidad de datos:

38.7M

Ruido acústico:

Fanless

Disipación de calor:

Natural heat dissipation

Temperatura de funcionamiento (° C):

0-40°C

Humedad de funcionamiento:

10%~90%

Features

General:

Spanning Tree :

802.1D STP

802.1s MSTP

802.1w RSTP

VLAN:

802.1Q VLAN

Port Based

Management VLAN

Voice VLAN

Link Aggregation

IEEE 802.3ad LACP

IGMP Snooping

Port Mirroring (One to One, Many to One)

Características de seguridad:

Port security
Access Control List
DHCP snooping
Dynamic ARP Inspection
DoS Protection
CPU Guard (CPU Protection)
Port Mirroring (One to One, Many to One)
Storm Control (Broadcast/Multicast/Unknown_Unicast)
ACL
MAC Filte
Port max count per port
SSHv1.5/v2.0
SSL

Características de gestión:

CLI/WEB Based
Telnet/SNMP v1/v2/v3
RMON I (1,2,3, 9 group)
Software Download
Event/Error Log/Syslog
Cable Diag Nostic.
Configuration Upload/Download
Even/Error/System log
Firmware Download/Upgrade
Daul Configuration
Daul Image

Facilidad de uso:

yes

Performance**Velocidad de reenvío de paquetes:**

1488000

Jumbo Frame (K):

10k

Physical Specifications**Dimensiones (W x D x H mm):**

440x208x44mm

Peso (gramos):

2kg

Reliability**MTBF:**

230000

Approval and Compliance**EMI/EMS:**

CE

Prueba ambiental:

RoHS



Diagrama

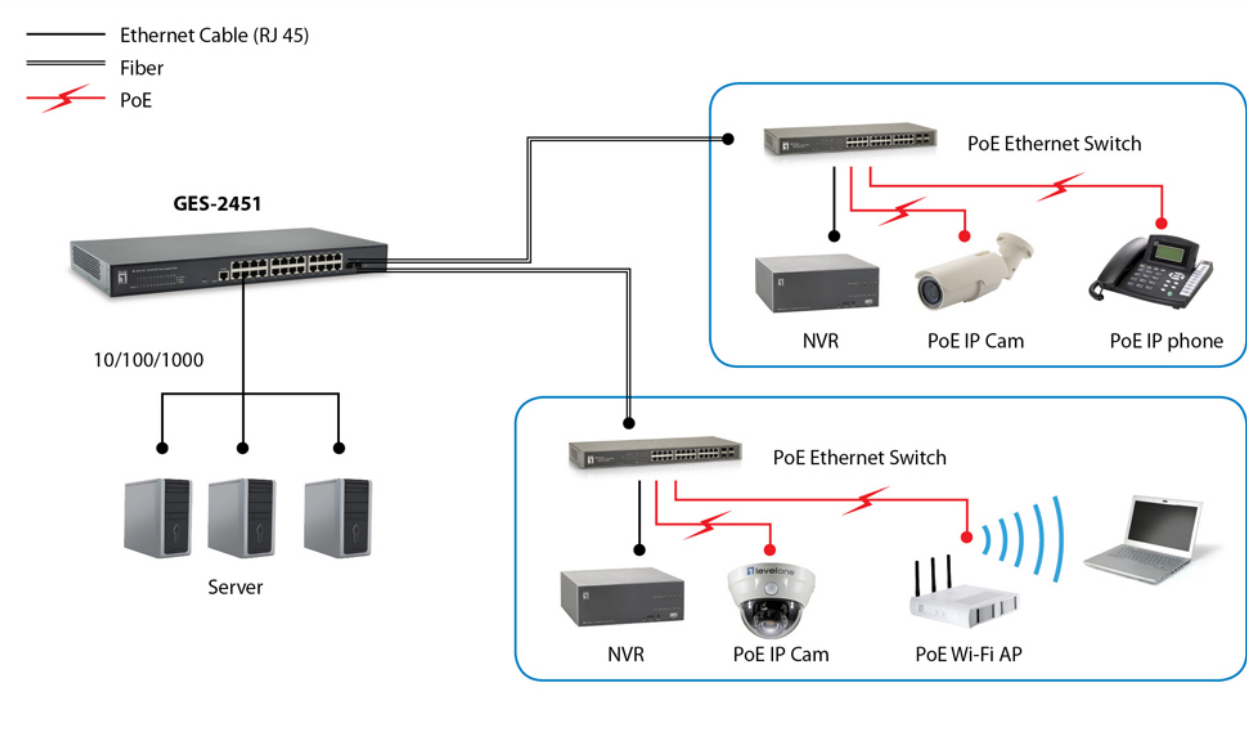

Order Information

GES-2451

Package Contents

- GES-2451
- Power Cord
- Resource CD (User Manual, QIG)
- Quick Installation Guide
- Rubber Feet
- 19" Rack Mount Kit

No liability or responsibility for any errors or omissions in the content.
Specifications are subject to change without notice.
All mentioned brand names are registered trademarks and property of their owners.
Copyright © Digital Data Communications GmbH, Germany. All Rights Reserved.